

**TECHNICAL SPECIFICATION:**

Product Code: **#SSHPRND50B**  
Post Type: Round Post  
Post Size: Ø50mm [Ø1-15/16"]  
Post Thickness: 4.8mm [3/16"]  
Post Height: 1377mm [54-3/16"]  
Post Configuration: Blank Post  
Post Material: Stainless Steel 316  
Post Finish: Satin

**INCLUDED:**

Swivel Tube Support **#SSHPZAC02**

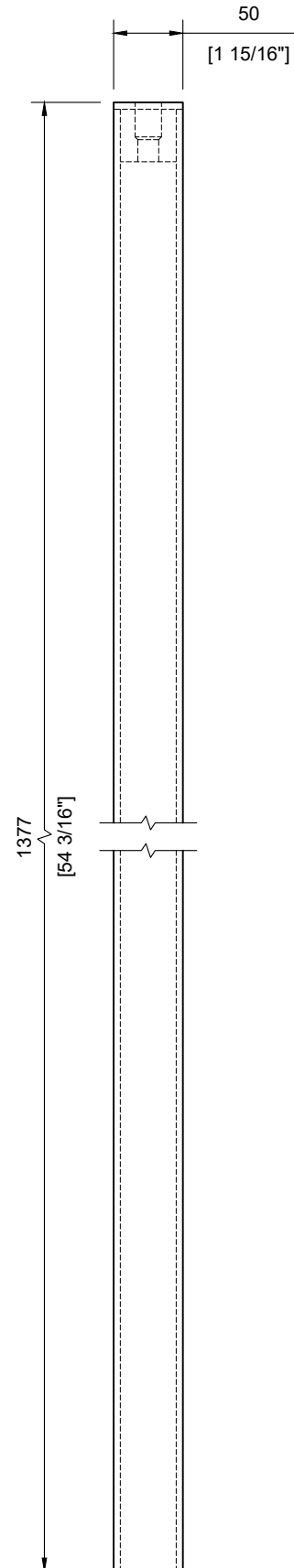
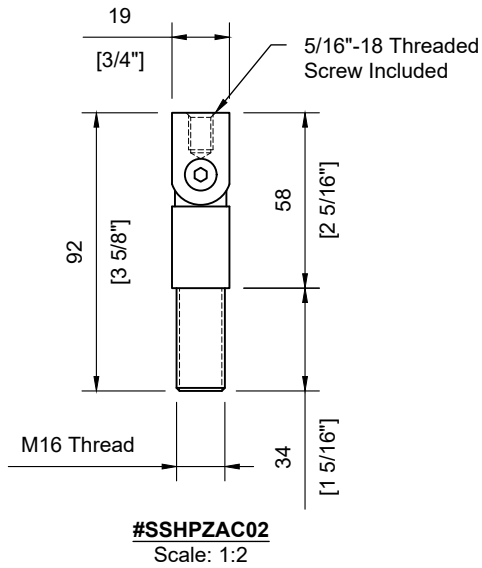

**#SSHPRND50B**  
Scale: 1:5

# **TECHNICAL SPECIFICATION:**

Product Code: **#SSHPRND50C**  
 Post Type: Round Post  
 Post Size: Ø50mm [Ø1-15/16"]  
 Post Thickness: 4.8mm [3/16"]  
 Post Height: 1012mm [39-13/16"]  
 Post Configuration: Corner Post  
 Post Material: Stainless Steel 316  
 Post Finish: Satin

## **INCLUDED:**

Fixed Tube Support **#SSHPZAC01**  
 Plate Cover **#SSHPRND50X5**

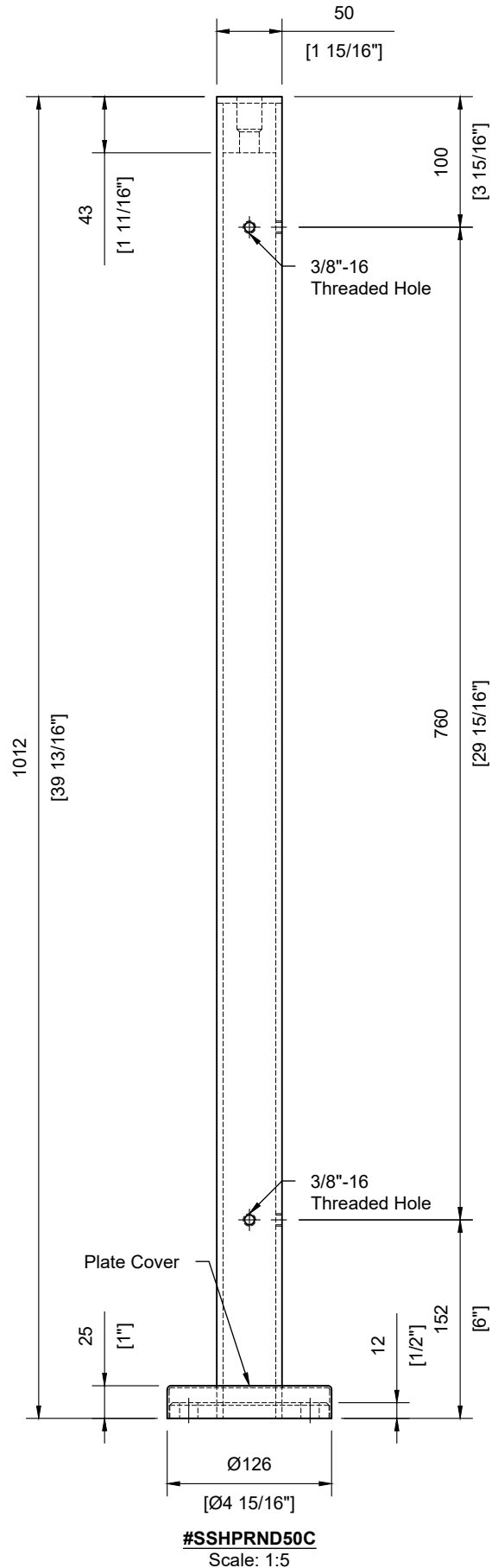
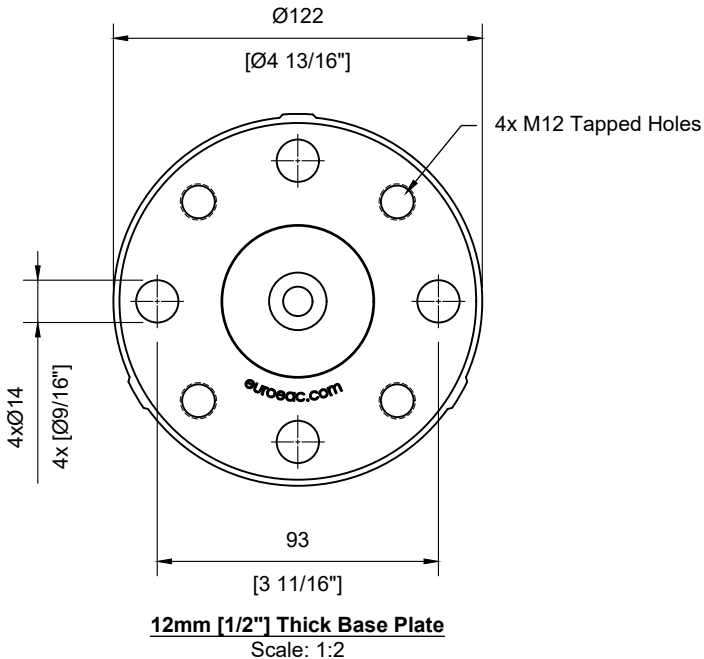
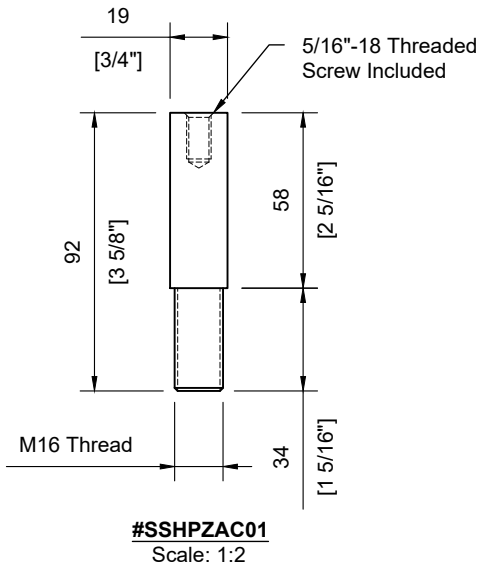

# TECHNICAL SPECIFICATION:

Product Code: **#SSHPRND50E**  
Post Type: Round Post  
Post Size: Ø50mm [Ø1-15/16"]  
Post Thickness: 4.8mm [3/16"]  
Post Height: 1012mm [39-13/16"]  
Post Configuration: End Post  
Post Material: Stainless Steel 316  
Post Finish: Satin

## INCLUDED:

Fixed Tube Support **#SSHPZAC01**  
Plate Cover **#SSHPRND50X5**

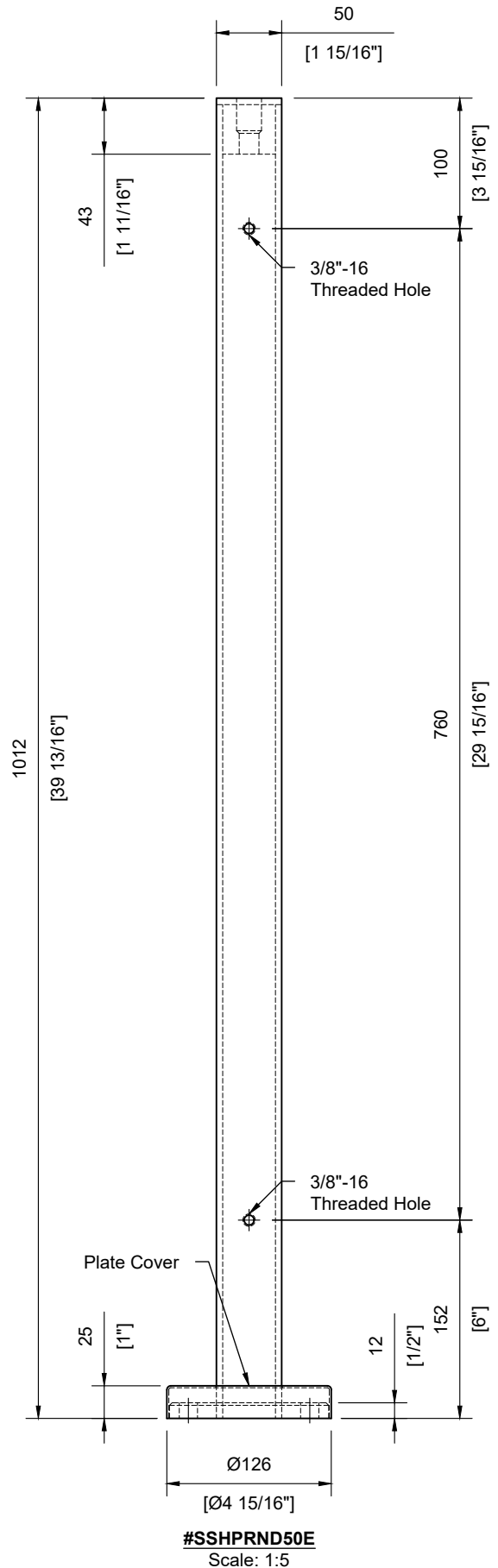
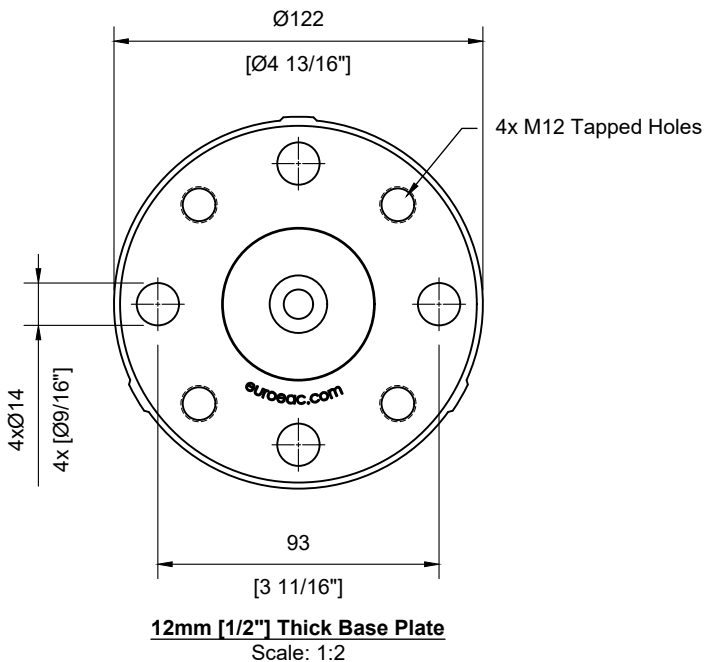
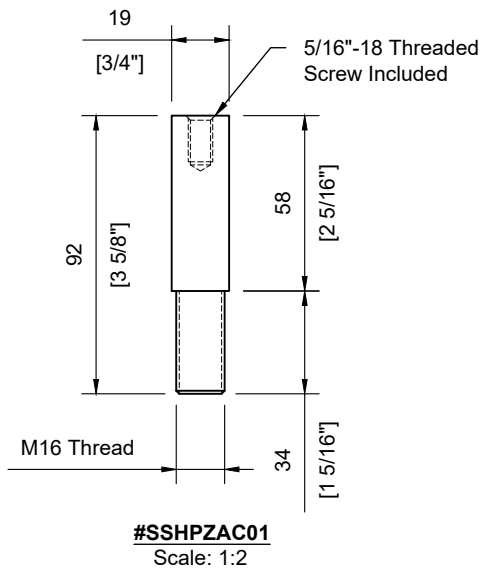

# TECHNICAL SPECIFICATION:

Product Code: **#SSHPRND50L**  
Post Type: Round Post  
Post Size: Ø50mm [Ø1-15/16"]  
Post Thickness: 4.8mm [3/16"]  
Post Height: 1012mm [39-13/16"]  
Post Configuration: Line Post  
Post Material: Stainless Steel 316  
Post Finish: Satin

## INCLUDED:

Fixed Tube Support **#SSHPZAC01**  
Plate Cover **#SSHPRND50X5**

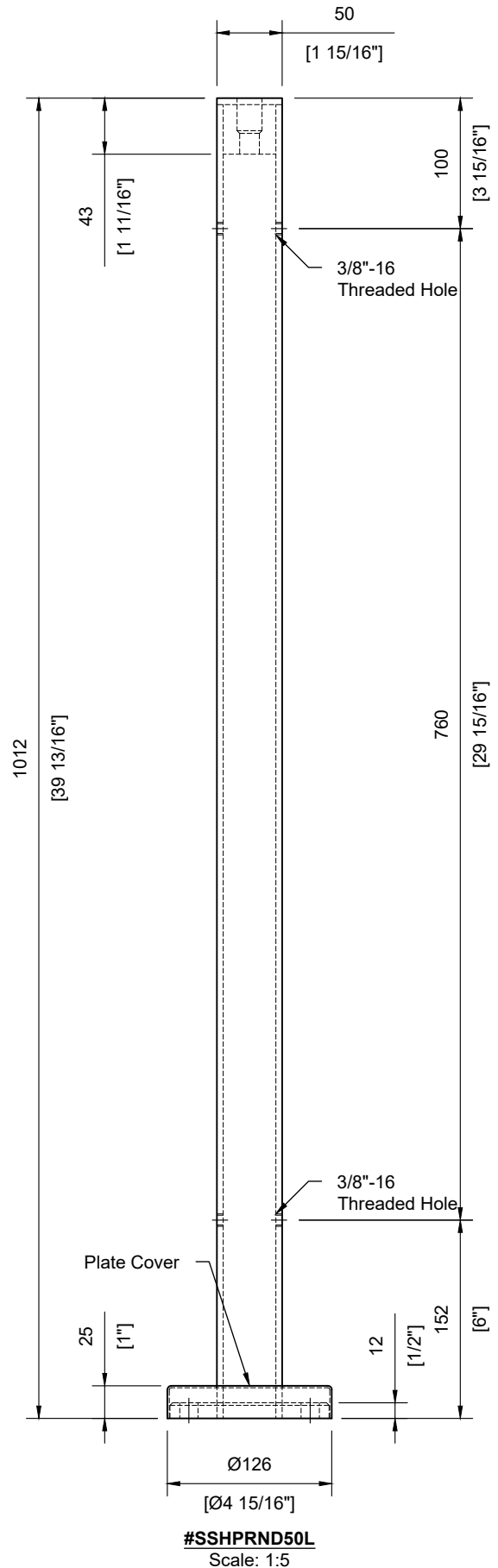
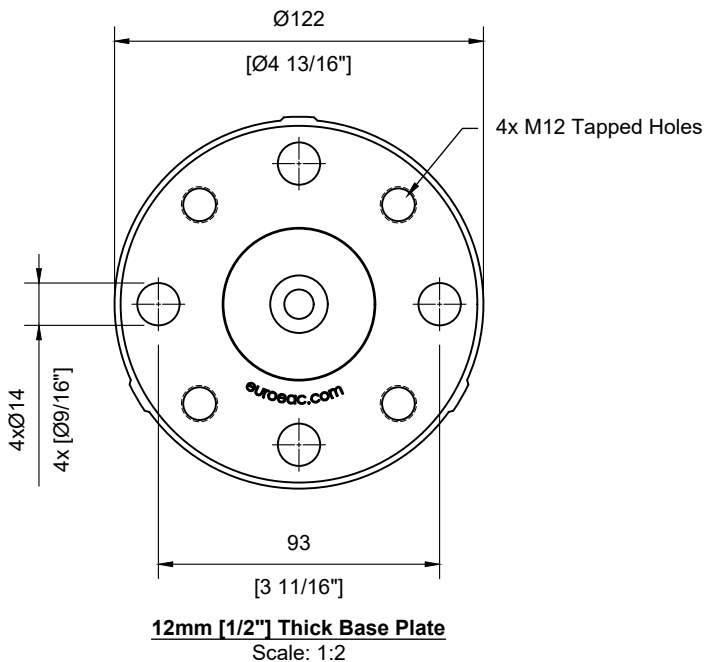
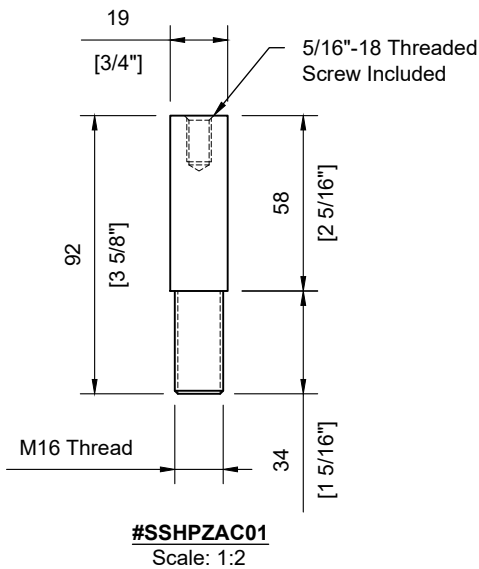

## TECHNICAL SPECIFICATION:

Product Code: **#SSHPRND50X1**  
Description: Round Back Glass Clips for Round Post  
Length: 58mm [2-5/16"]  
Height: 54mm [2-1/8"]  
Glass Thickness: 12mm [1/2"] to 13.52mm [9/16"]  
Material: Stainless Steel 316  
Finish: Satin

## INCLUDED:

Stainless Steel Screw 3/8"-16 x 25mm [1"] Pan Head Screw  
Rubber Gasket 12mm [1/2"] and 13.52mm [9/16"]

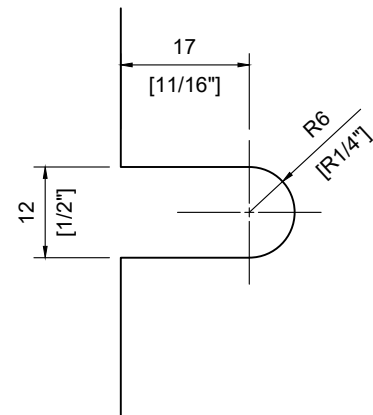
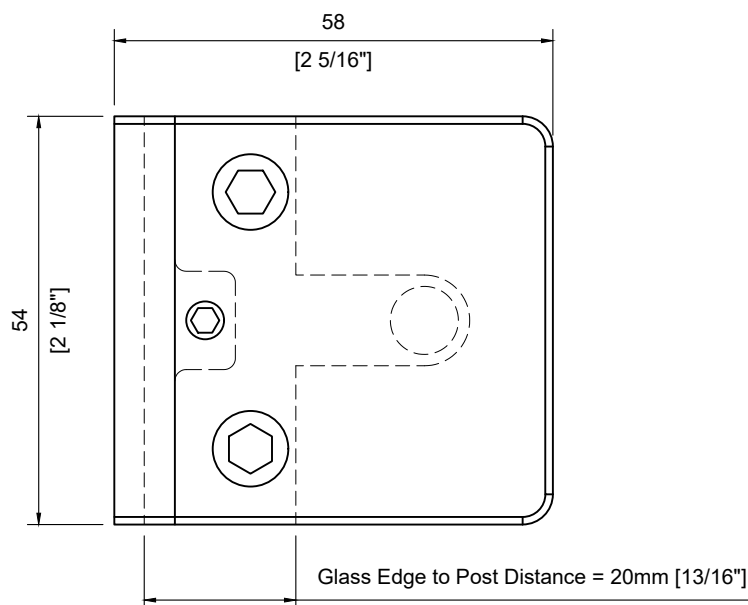
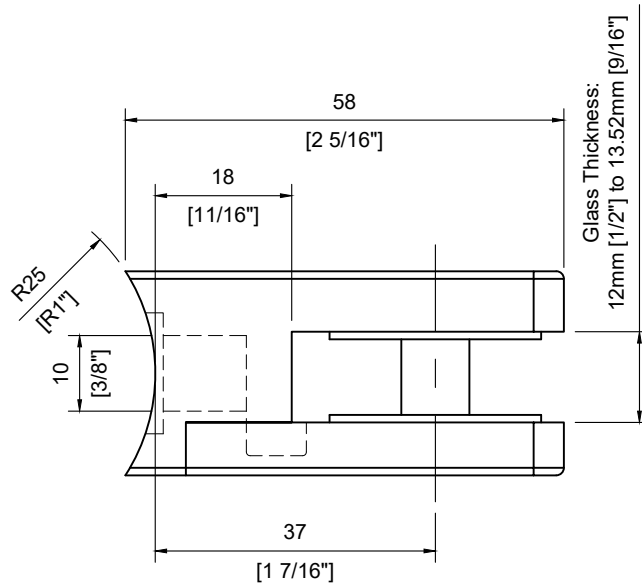

**Glass Cut-out**

TECHNICAL SPECIFICATION:

Product Code: #SSHPRND50X2  
Description: Round End Cap for Round Post  
Size: Ø50mm [Ø1-15/16"]  
Thickness: 5mm [3/16"]  
Material: Stainless Steel 316  
Finish: Satin

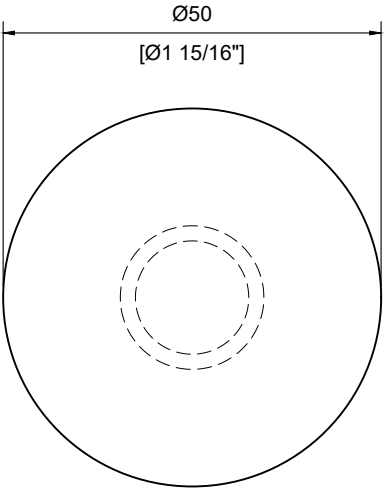
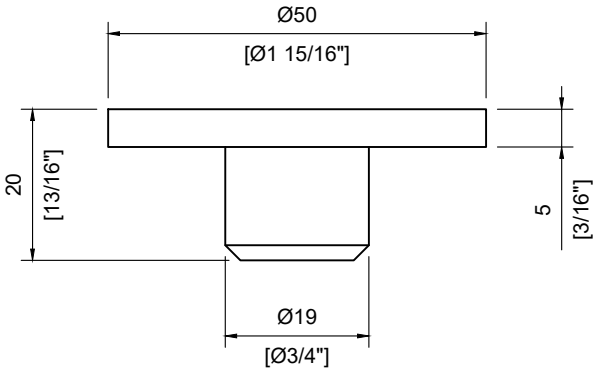

# TECHNICAL SPECIFICATION:

Product Code: **#SSHPRND50X3**  
Description: Round Base Plate for Round Post  
Size: Ø122mm [Ø4-13/16"]  
Thickness: 12mm [1/2"]  
Material: Stainless Steel 316  
Finish: Bare

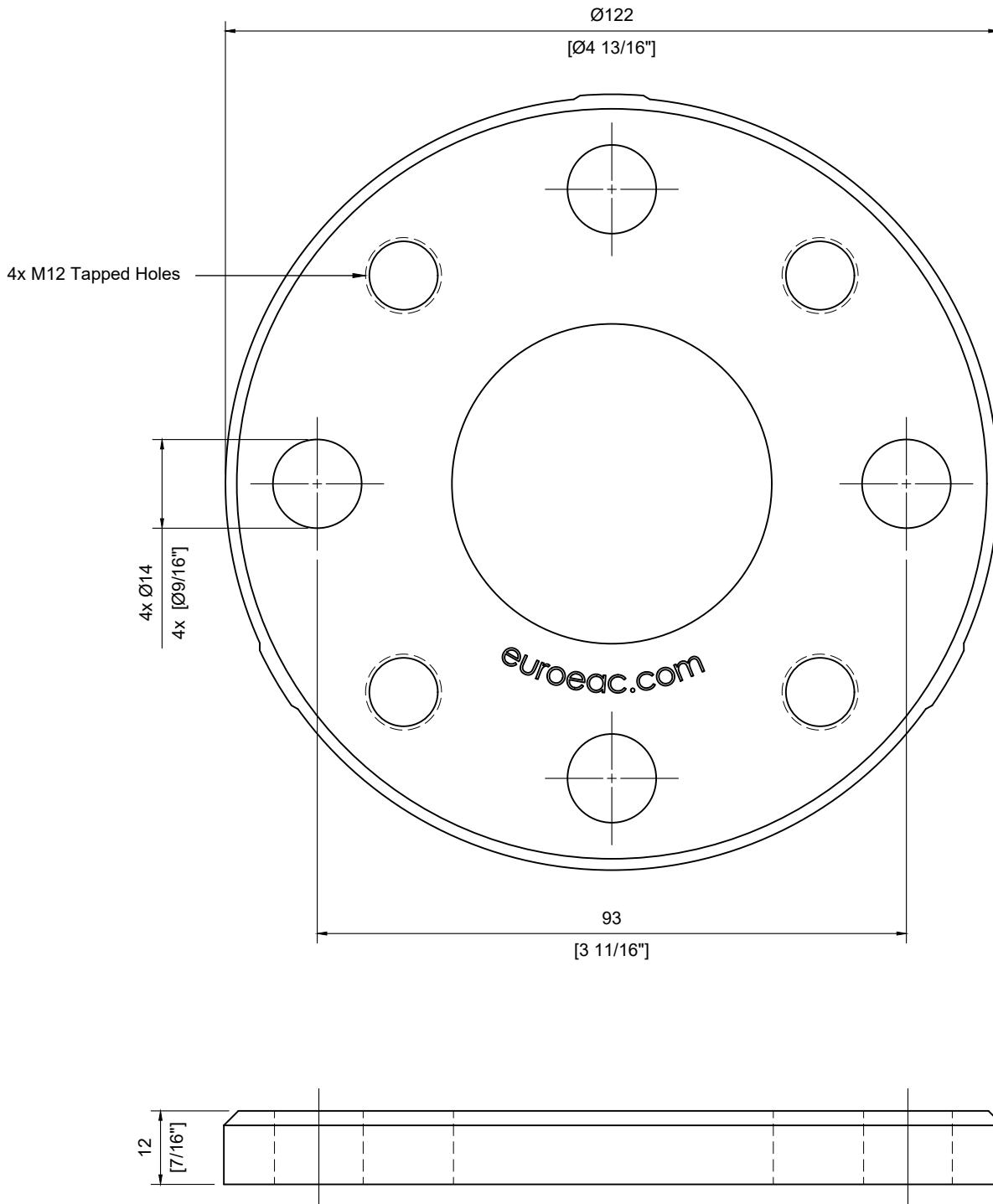

TECHNICAL SPECIFICATION:

Product Code: #SSHPRND50X4  
Description: Round Leveling Plate for Round Post  
Size: Ø122mm [Ø4-13/16"]  
Thickness: 2mm [1/16"]  
Material: Stainless Steel 316  
Finish: Bare

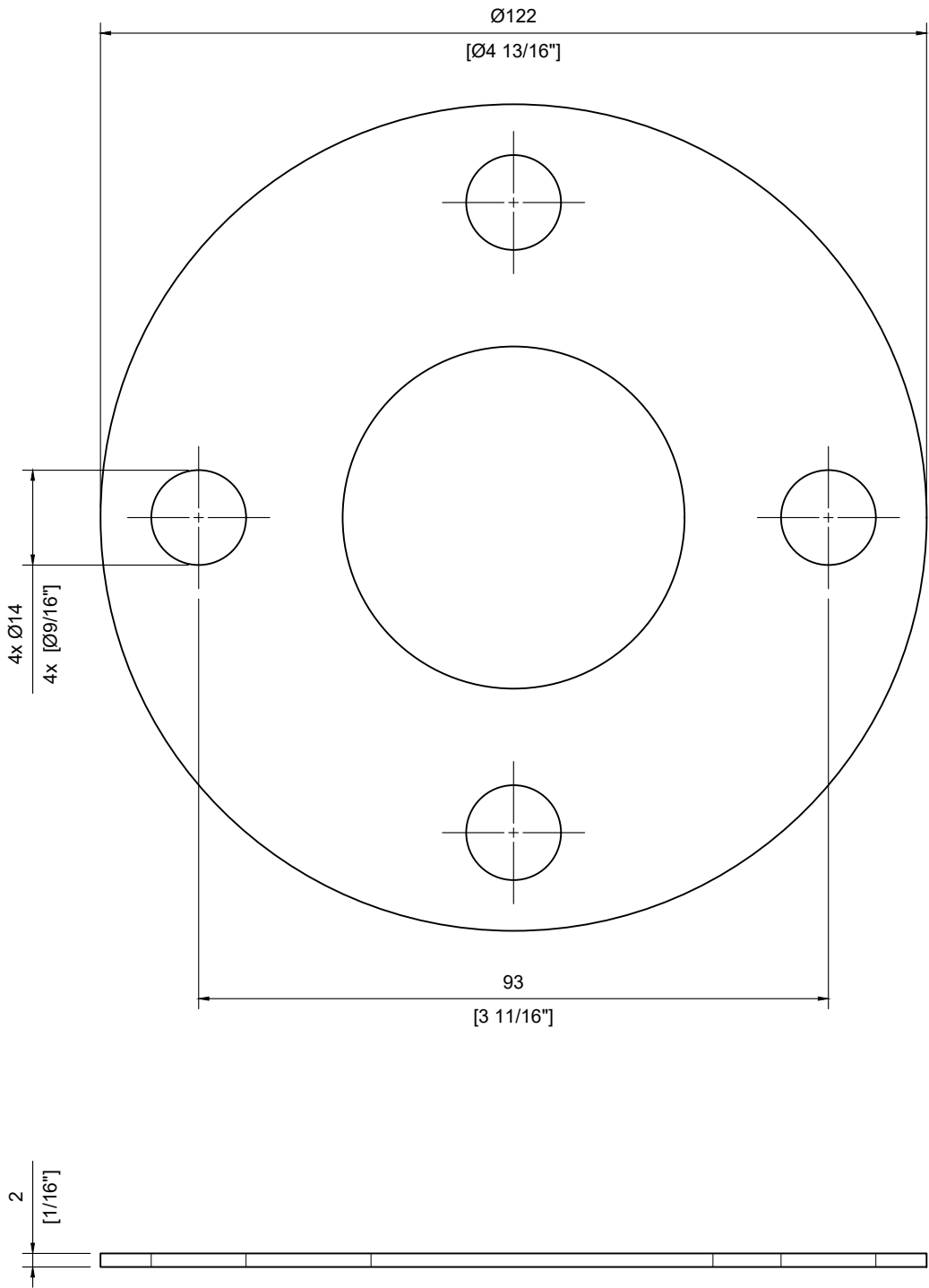

TECHNICAL SPECIFICATION:

Product Code: #SSHPRND50X5  
Description: Round Plate Cover for Round Post  
Size: Ø126mm [Ø4-15/16"]  
Thickness: 1.5mm [1/16"]  
Height: 25mm [1"]  
Material: Stainless Steel 316  
Finish: Satin

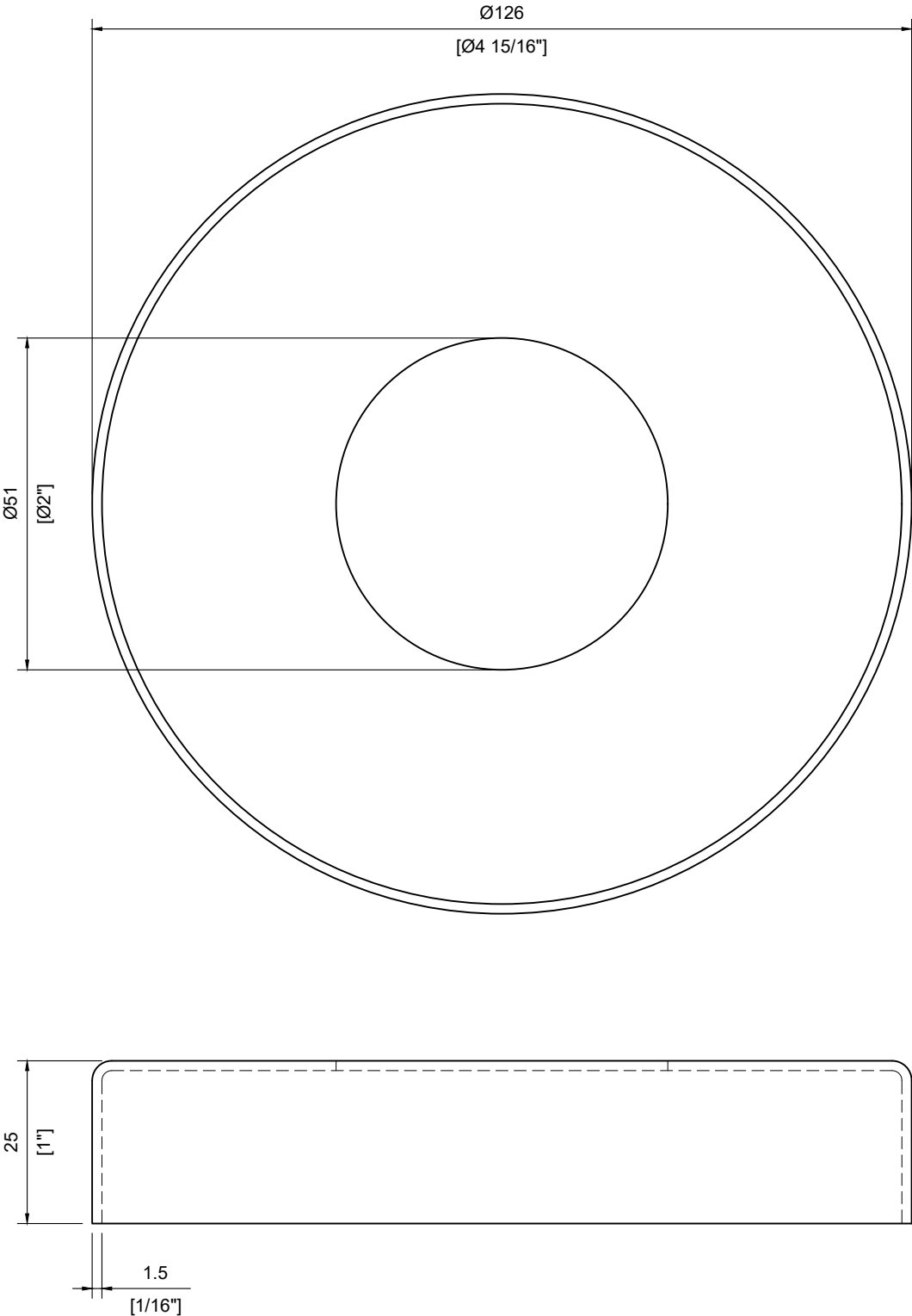

# TECHNICAL SPECIFICATION:

Product Code: **#SSHPRND50X6**  
Description: Round Stanchion for Round Post  
Size: Ø122mm [Ø4-13/16"]  
Thickness: 12mm [1/2"]  
Height: 140mm [4-3/4"]  
Material: Stainless Steel 316  
Finish: Bare

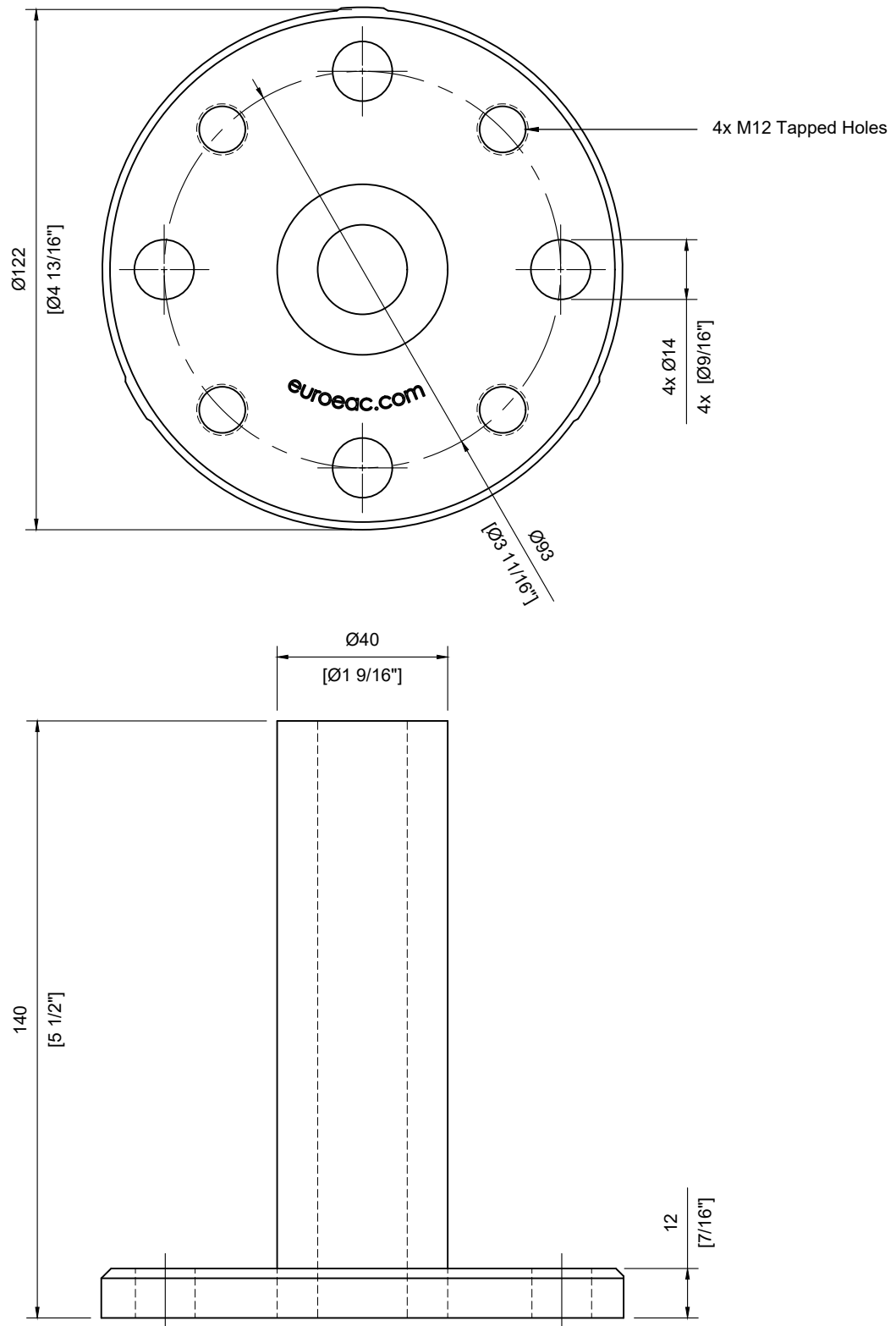

Scale: 1:1.5

# TECHNICAL SPECIFICATION:

Product Code: **#SSHPSQR50B**  
Post Type: Square Post  
Post Size: 50mm [1-15/16"] x 50mm [1-15/16"]  
Post Thickness: 4.8mm [3/16"]  
Post Height: 1377mm [54-3/16"]  
Post Configuration: Blank Post  
Post Material: Stainless Steel 316  
Post Finish: Satin

## INCLUDED:

Swivel Tube Support **#SSHPZAC02**

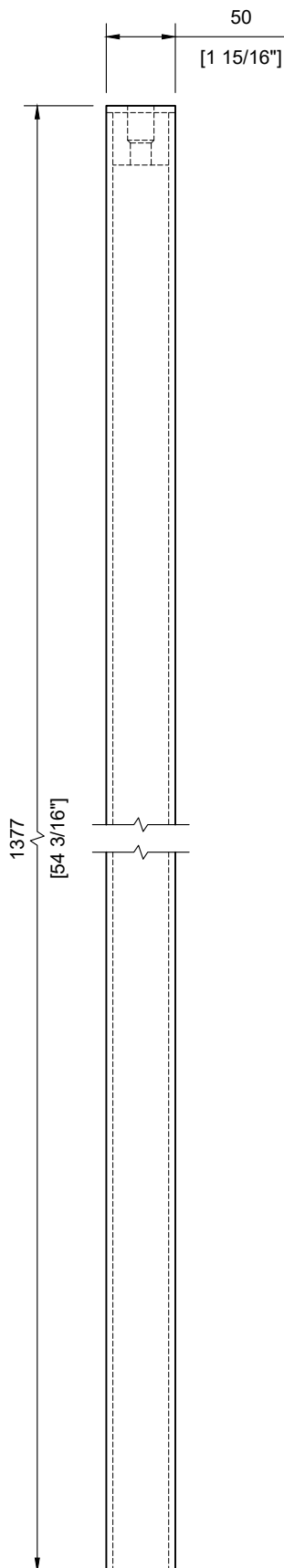
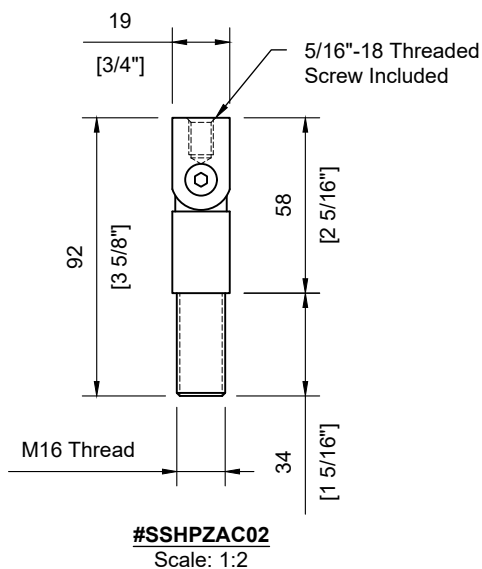

# **TECHNICAL SPECIFICATION:**

Product Code: **#SSHPSQR50C**  
 Post Type: Square Post  
 Post Size: 50mm [1-15/16"] x 50mm [1-15/16"]  
 Post Thickness: 4.8mm [3/16"]  
 Post Height: 1012mm [39-13/16"]  
 Post Configuration: Corner Post  
 Post Material: Stainless Steel 316  
 Post Finish: Satin

## **INCLUDED:**

Fixed Tube Support **#SSHPZAC01**  
 Plate Cover **#SSHPSQR50X5**

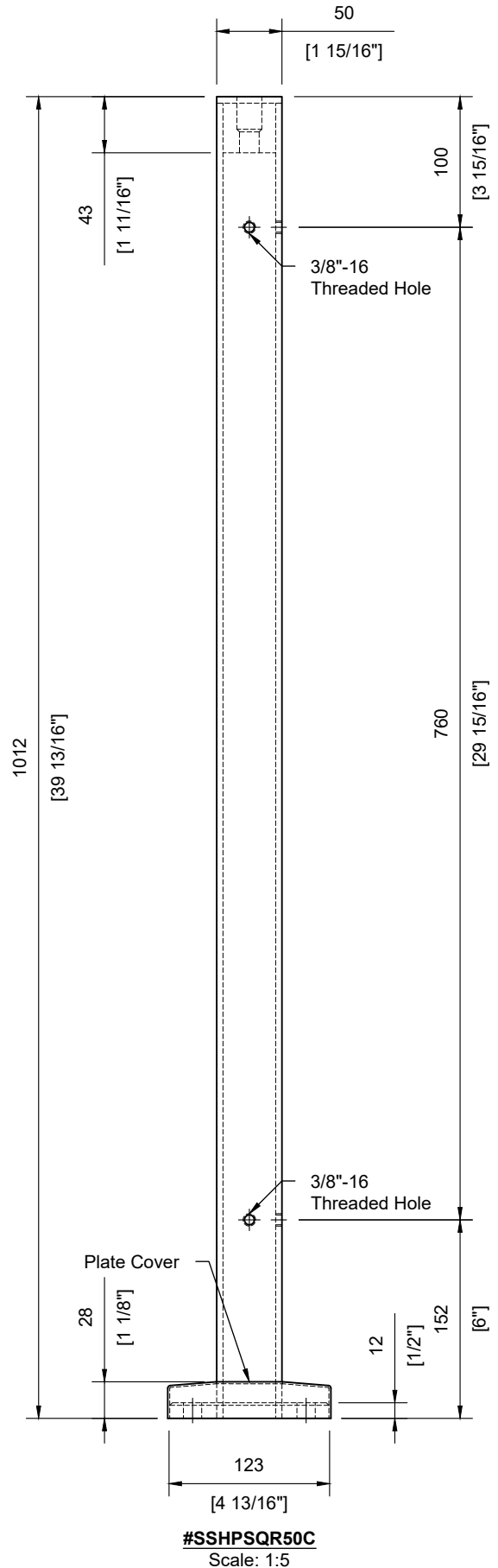
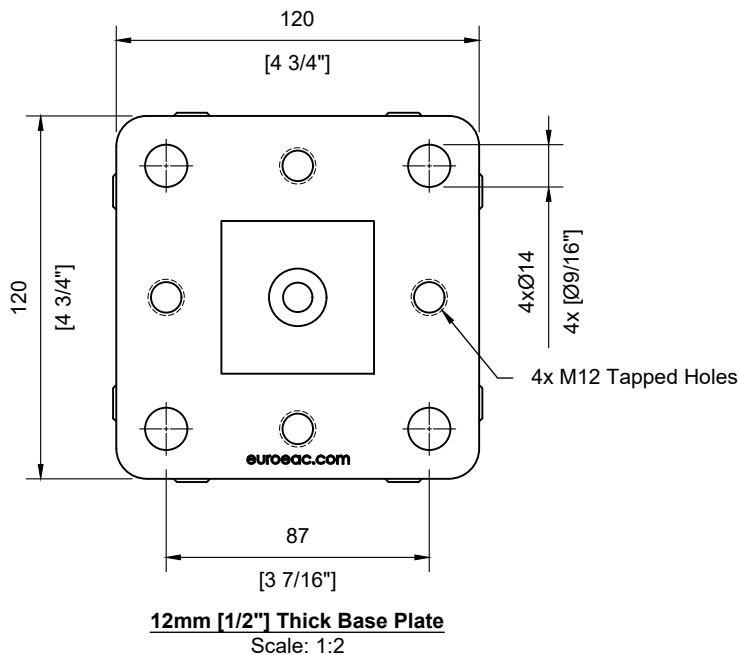
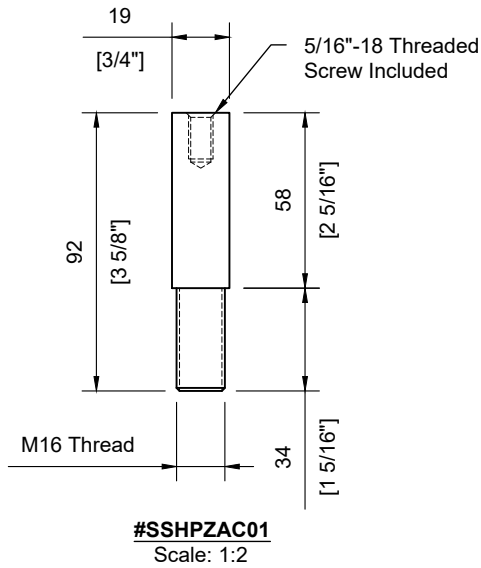

# TECHNICAL SPECIFICATION:

Product Code: **#SSHPSQR50E**  
Post Type: Square Post  
Post Size: 50mm [1-15/16"] x 50mm [1-15/16"]  
Post Thickness: 4.8mm [3/16"]  
Post Height: 1012mm [39-13/16"]  
Post Configuration: End Post  
Post Material: Stainless Steel 316  
Post Finish: Satin

## INCLUDED:

Fixed Tube Support **#SSHPZAC01**  
Plate Cover **#SSHPSQR50X5**

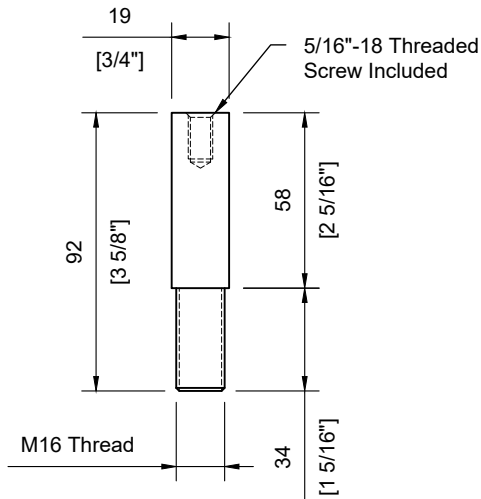

**#SSHPZAC01**  
Scale: 1:2

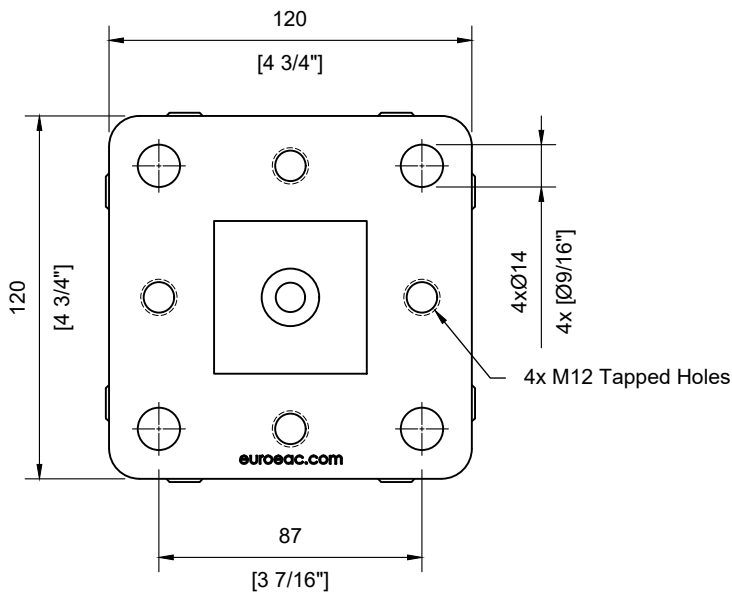

**12mm [1/2"] Thick Base Plate**  
Scale: 1:2

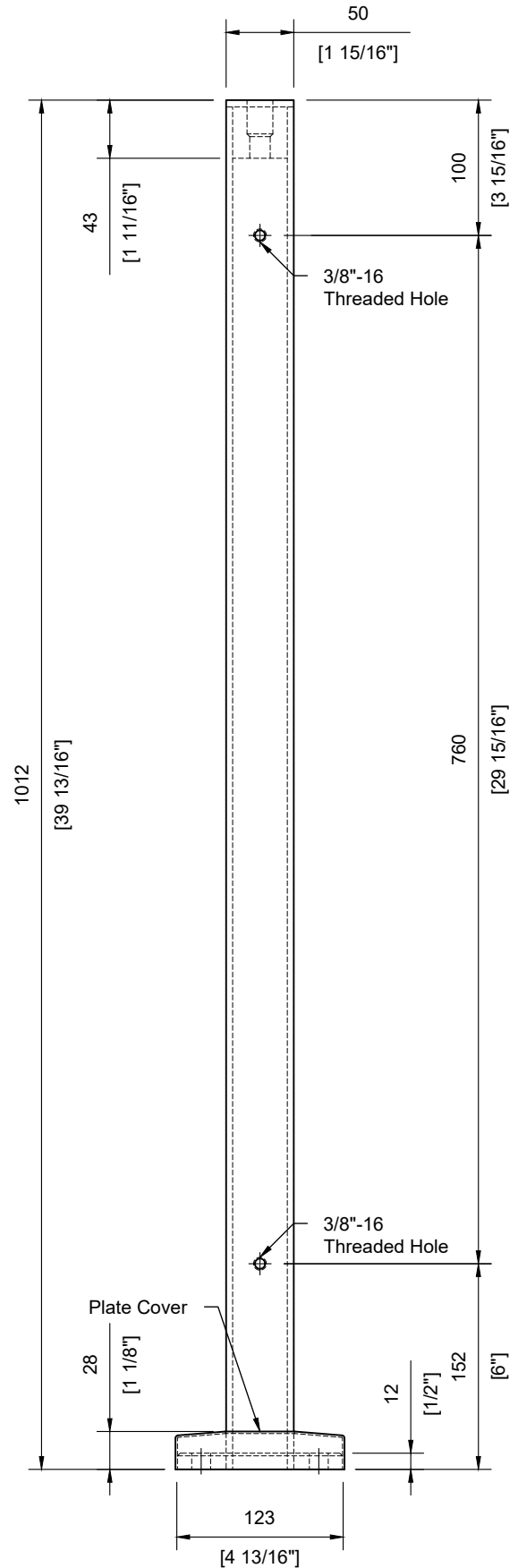

**#SSHPSQR50E**  
Scale: 1:5

## TECHNICAL SPECIFICATION:

Product Code: **#SSHPSQR50L**  
Post Type: Square Post  
Post Size: 50mm [1-15/16"] x 50mm [1-15/16"]  
Post Thickness: 4.8mm [3/16"]  
Post Height: 1012mm [39-13/16"]  
Post Configuration: Line Post  
Post Material: Stainless Steel 316  
Post Finish: Satin

## INCLUDED:

Fixed Tube Support **#SSHPZAC01**  
Plate Cover **#SSHPSQR50X5**

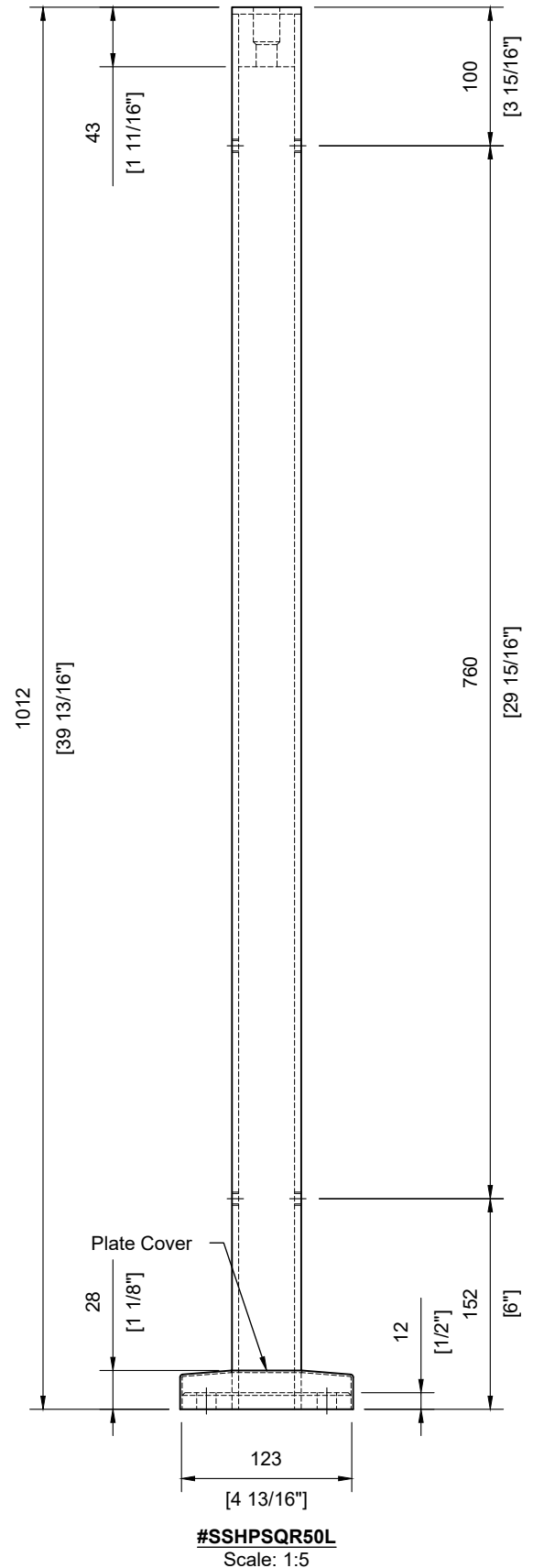
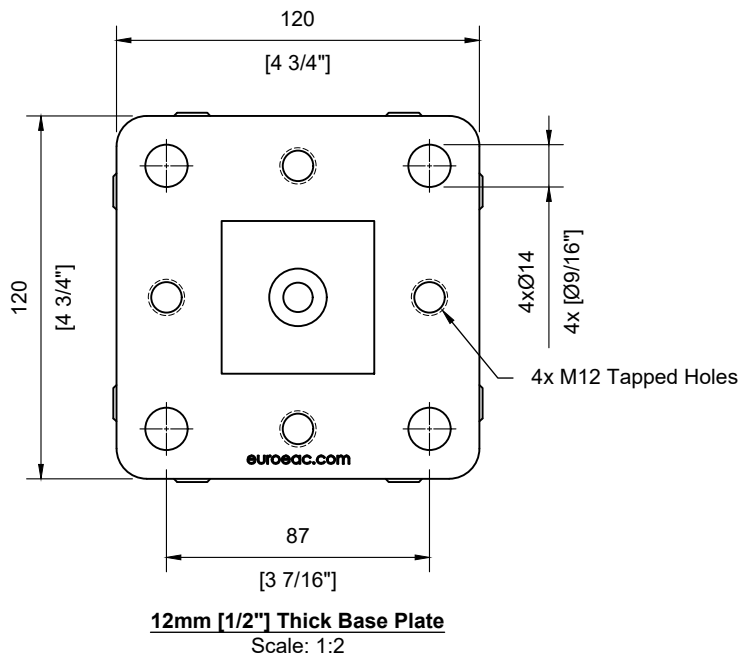
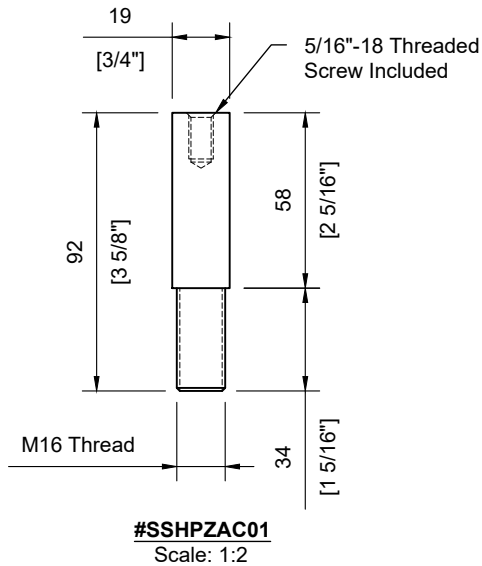

# TECHNICAL SPECIFICATION:

Product Code: **#SSHPSQR50X1**  
Description: Flat Back Glass Clips for Square Post  
Length: 54mm [2-1/8"]  
Height: 54mm [2-1/8"]  
Glass Thickness: 12mm [1/2"] to 13.52mm [9/16"]  
Material: Stainless Steel 316  
Finish: Satin

## INCLUDED:

Stainless Steel Screw 3/8"-16 x 25mm [1"] Pan Head  
Rubber Gasket 12mm [1/2"] and 13.52mm [9/16"]

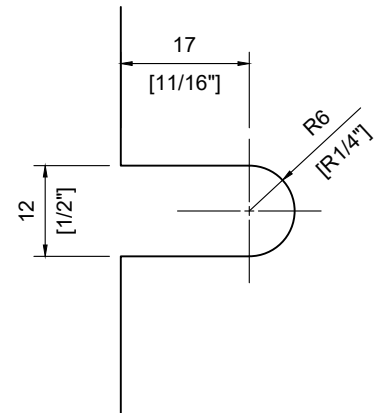
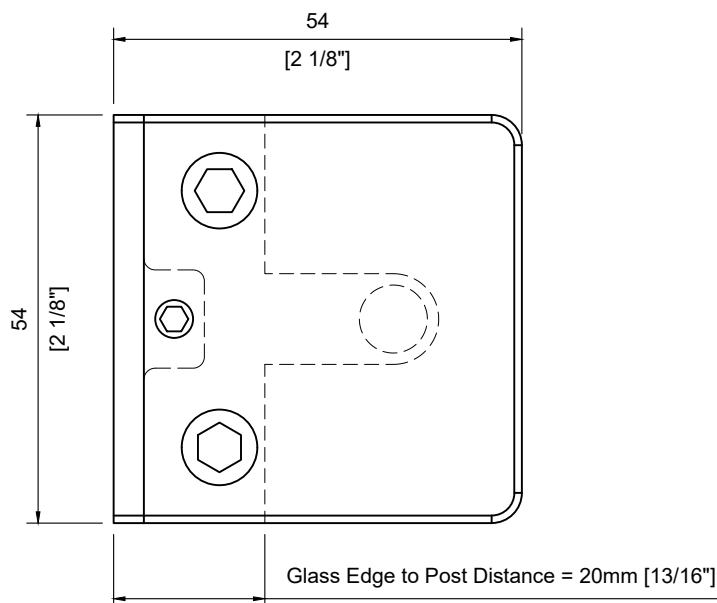
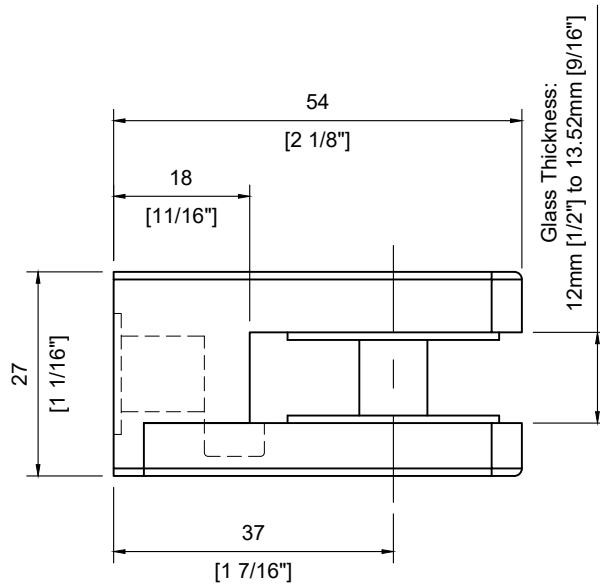

**Glass Cut-out**

TECHNICAL SPECIFICATION:

Product Code: #SSHPSQR50X2  
Description: Square End Cap for Square Post  
Size: 50mm [1-15/16"] x 50mm [1-15/16"]  
Thickness: 5mm [3/16"]  
Material: Stainless Steel 316  
Finish: Satin

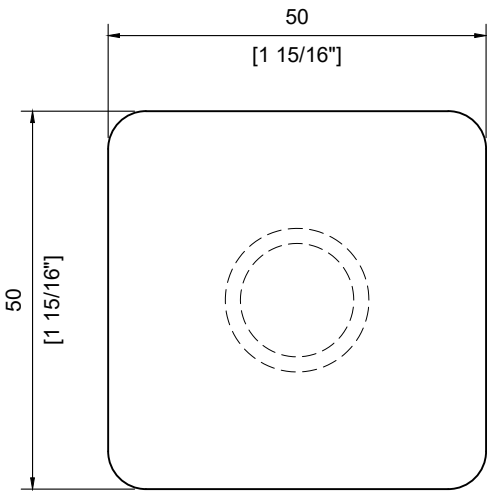
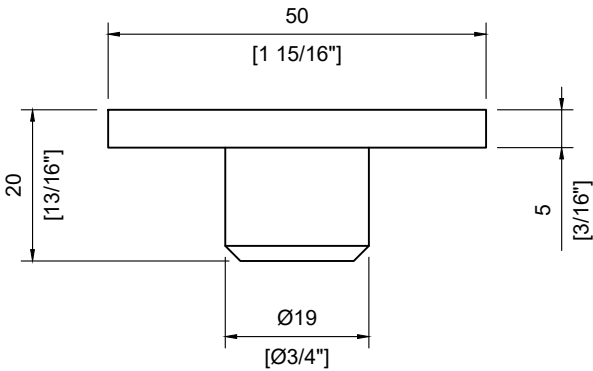

# TECHNICAL SPECIFICATION:

Product Code: **#SSHPSQR50X3**  
Description: Square Base Plate for Square Post  
Size: 120mm [4-3/4"] x 120mm [4-3/4"]  
Thickness: 12mm [1/2"]  
Material: Stainless Steel 316  
Finish: Bare

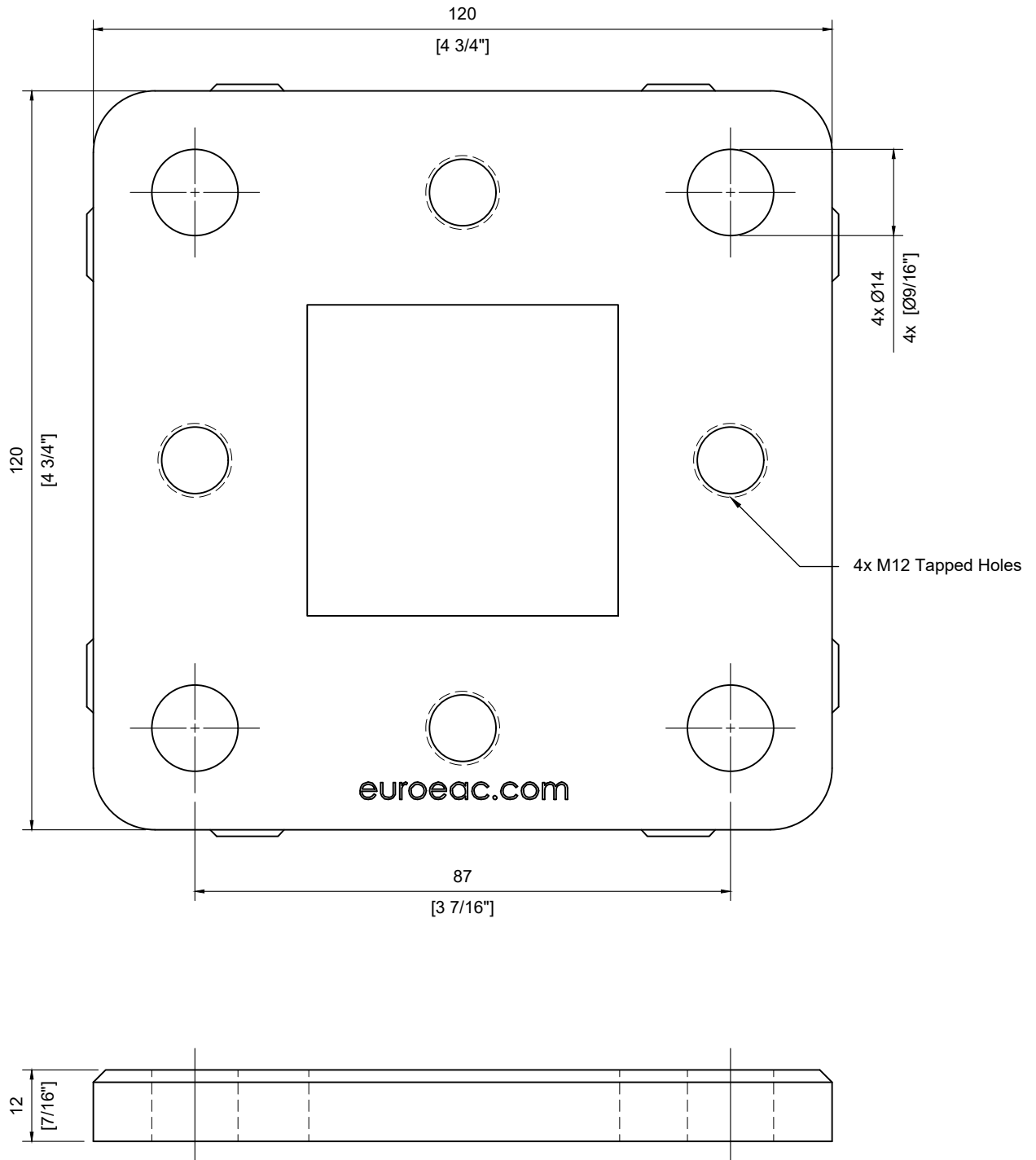

TECHNICAL SPECIFICATION:

Product Code: #SSHPSQR50X4  
Description: Square Leveling Plate for Square Post  
Size: 120mm [4-3/4"] x 120mm [4-3/4"]  
Thickness: 2mm [1/16"]  
Material: Stainless Steel 316  
Finish: Bare

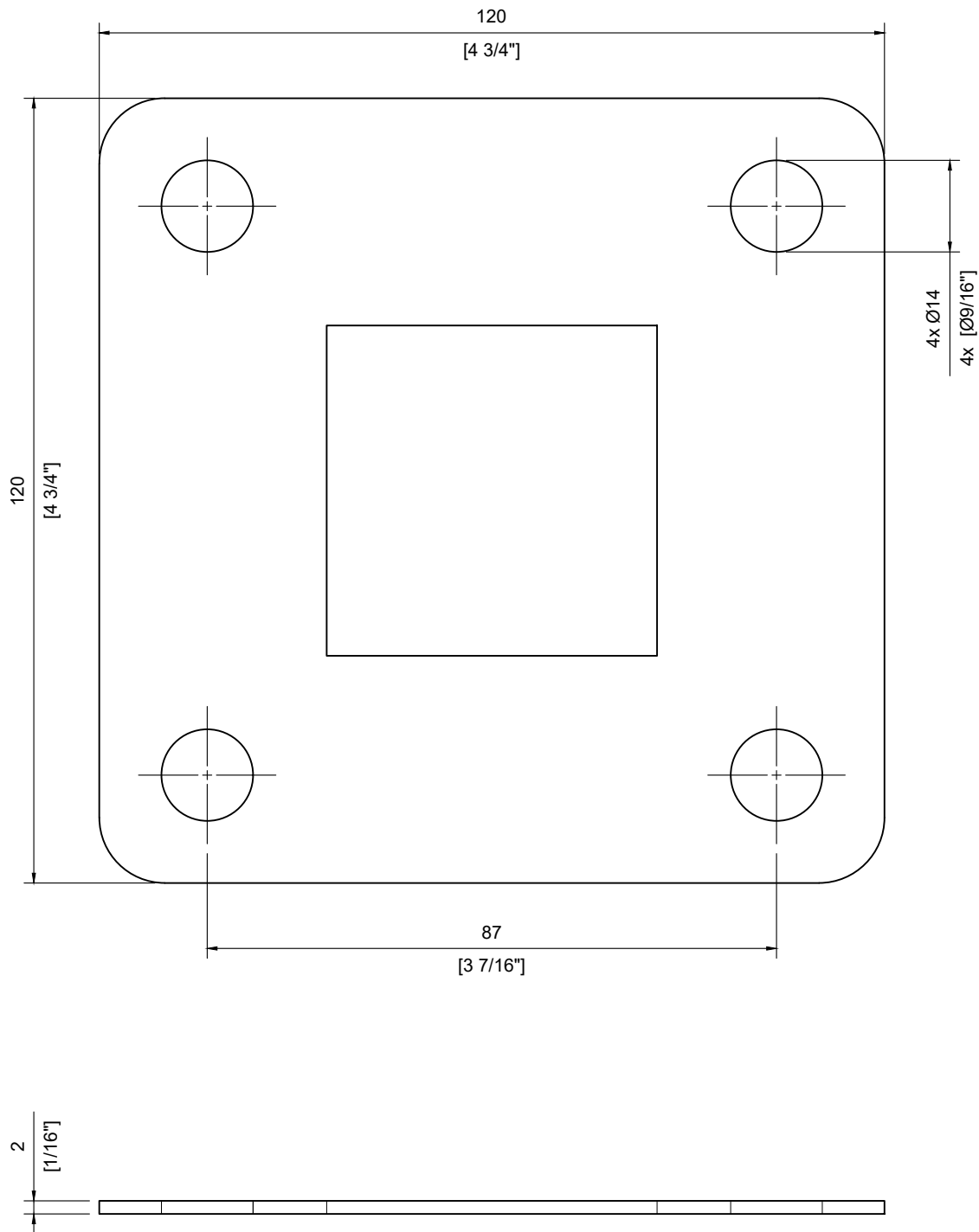

TECHNICAL SPECIFICATION:

Product Code: #SSHPSQR50X5  
Description: Square Plate Cover for Square Post  
Size: 125mm [4-15/16"] x 125mm [4-15/16"]  
Thickness: 1.5mm [1/16"]  
Height: 25mm [1"]  
Material: Stainless Steel 316  
Finish: Satin

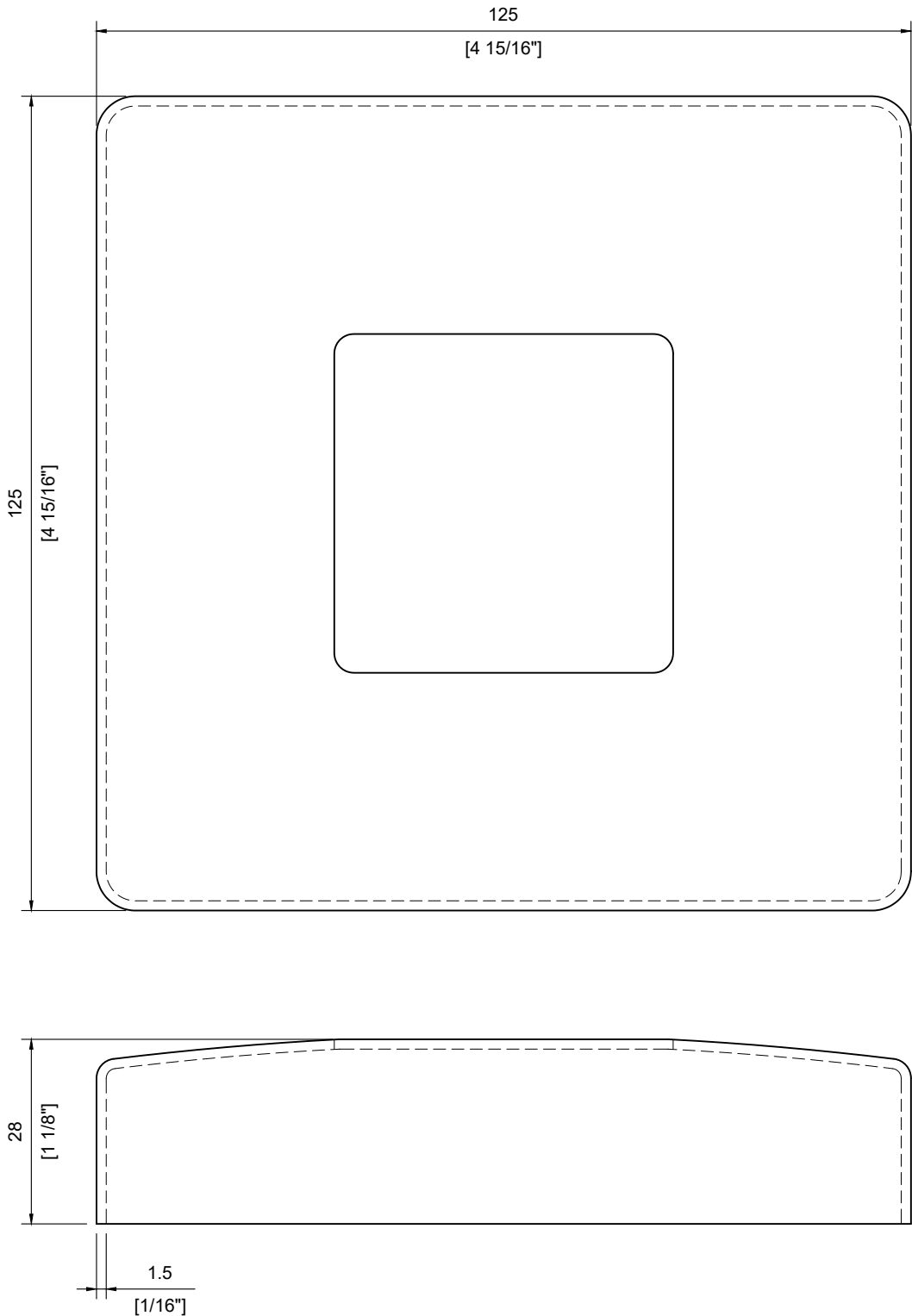

# TECHNICAL SPECIFICATION:

Product Code: **#SSHPSQR50X6**  
Description: Square Stanchion for Square Post  
Size: 120mm [4-3/4"] x 120mm [4-3/4"]  
Thickness: 12mm [1/2"]  
Height: 140mm [4 3/4"]  
Material: Stainless Steel 316  
Finish: Bare

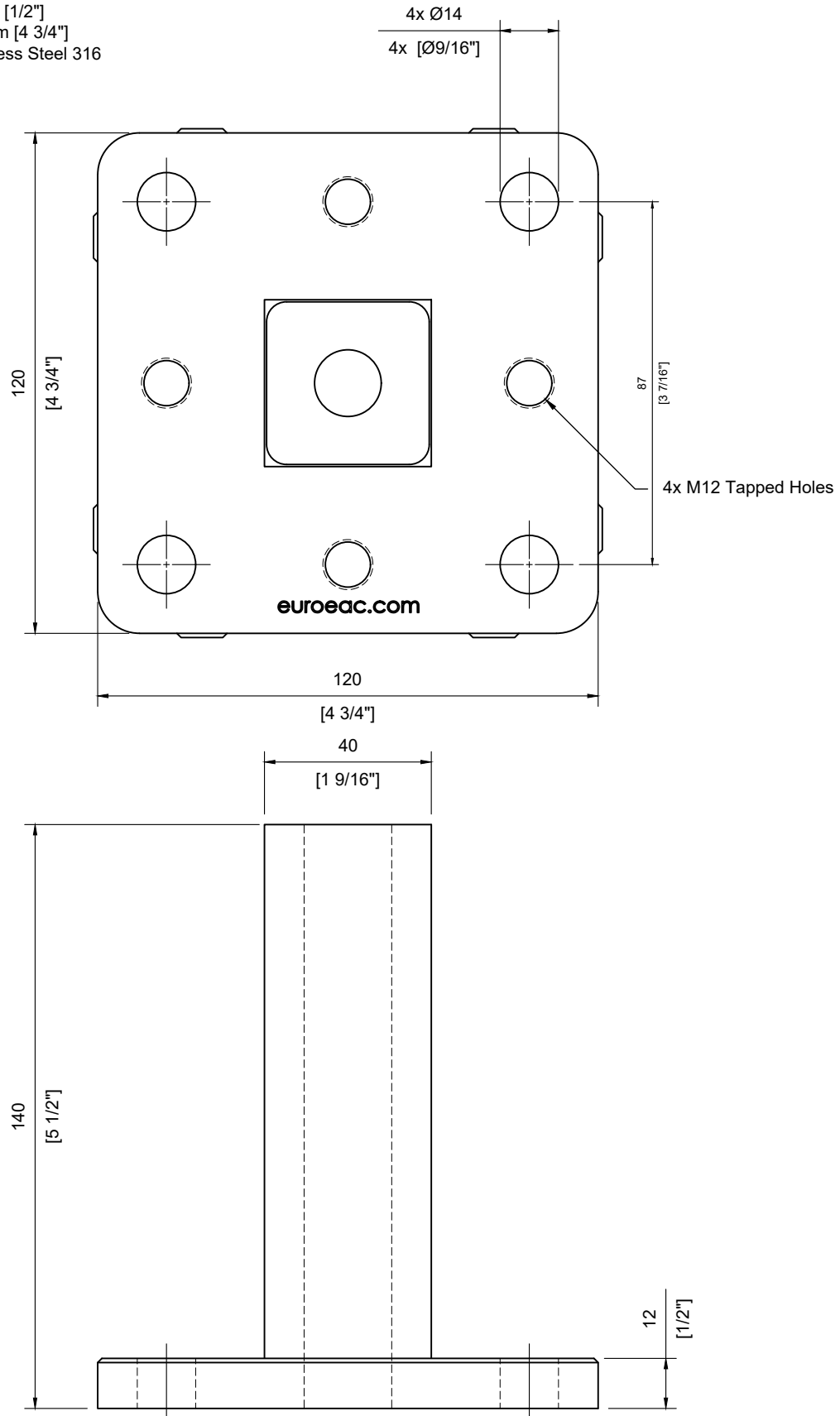

Scale: 1:1.5

TECHNICAL SPECIFICATION:

Product Code: #SSHPZAC01  
Description: Fixed Tube Support  
Size: Ø19mm [Ø3/4"]  
Height: 58mm [2-5/16"]  
Material: Stainless Steel 316  
Finish: Satin

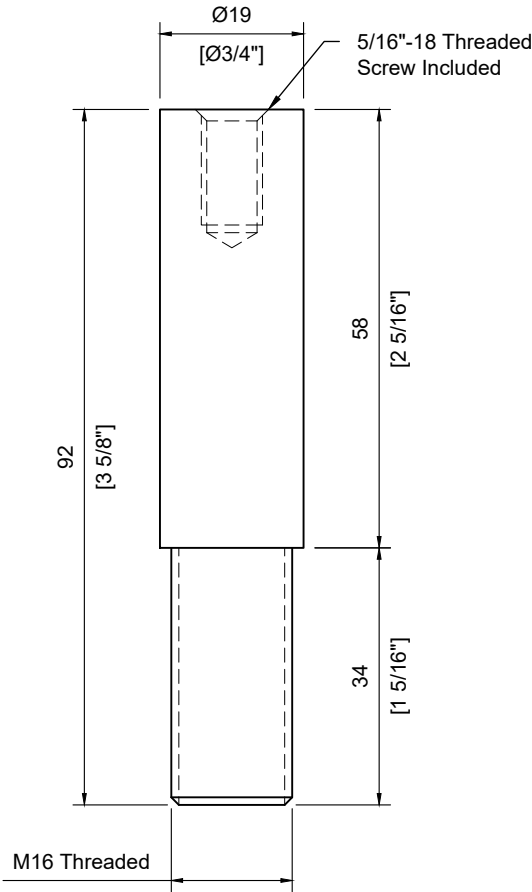

TECHNICAL SPECIFICATION:

Product Code: #SSHZAC02  
Description: Swivel Tube Support  
Size: Ø19mm [Ø3/4"]  
Height: 58mm [2-5/16"]  
Material: Stainless Steel 316  
Finish: Satin

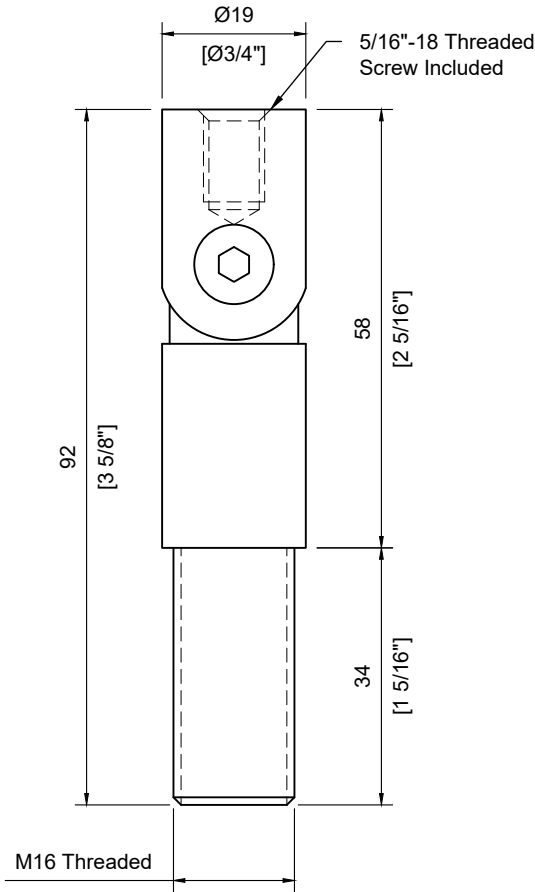

# **TECHNICAL SPECIFICATION:**

Product Code: **#SSHPZAC03**  
 Description: Curved 180° Handrail Attachment Plate  
 Handrail Size: Ø42.4mm [Ø1-11/16"]  
 Length: 85mm [3-5/16"]  
 Width: 25mm [1"]  
 Thickness: 5mm [3/16"]  
 Material: Stainless Steel 316  
 Finish: Satin

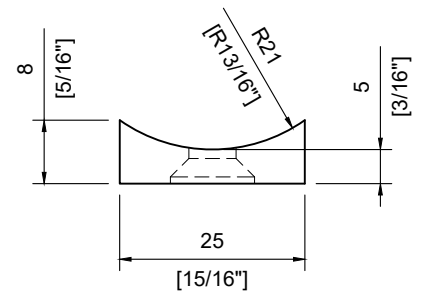
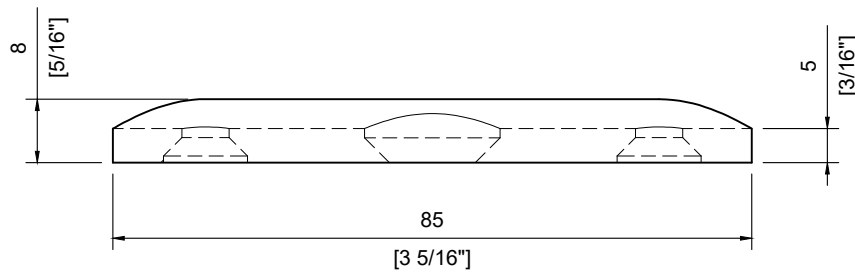
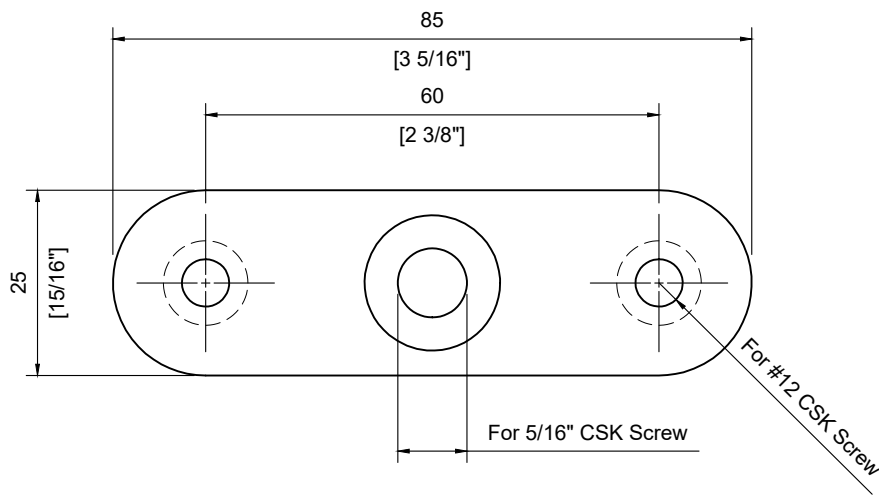

# TECHNICAL SPECIFICATION:

Product Code: **#SSHPZAC04**  
Description: Curved 90° Handrail Attachment Plate  
Handrail Size: Ø42.4mm [Ø1-11/16"]  
Length: 55mm [2-1/8"]  
Width: 25mm [1"]  
Thickness: 5mm [3/16"]  
Material: Stainless Steel 316  
Finish: Satin

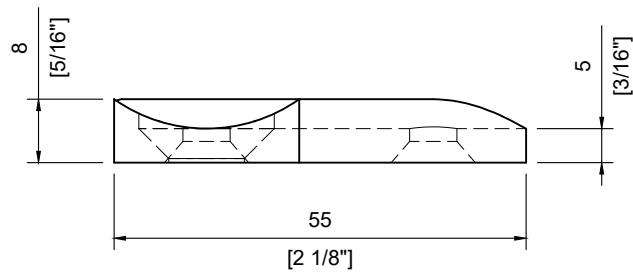
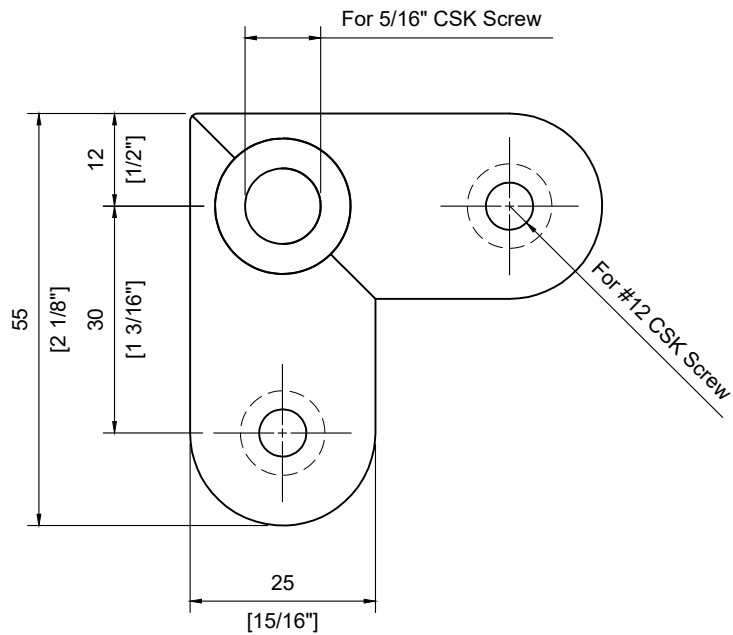

# TECHNICAL SPECIFICATION:

Product Code: **#SSHPZAC05**  
Description: Flat 180° Handrail Attachment Plate  
Length: 85mm [3-5/16"]  
Width: 25mm [1"]  
Thickness: 5mm [3/16"]  
Material: Stainless Steel 316  
Finish: Satin

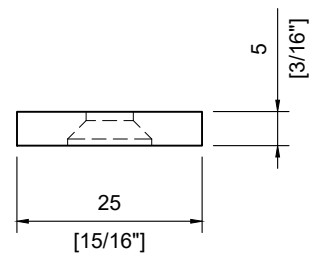
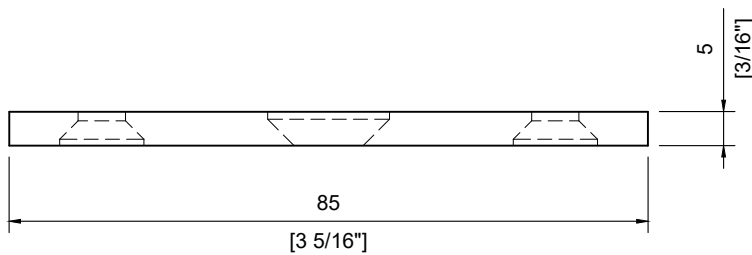
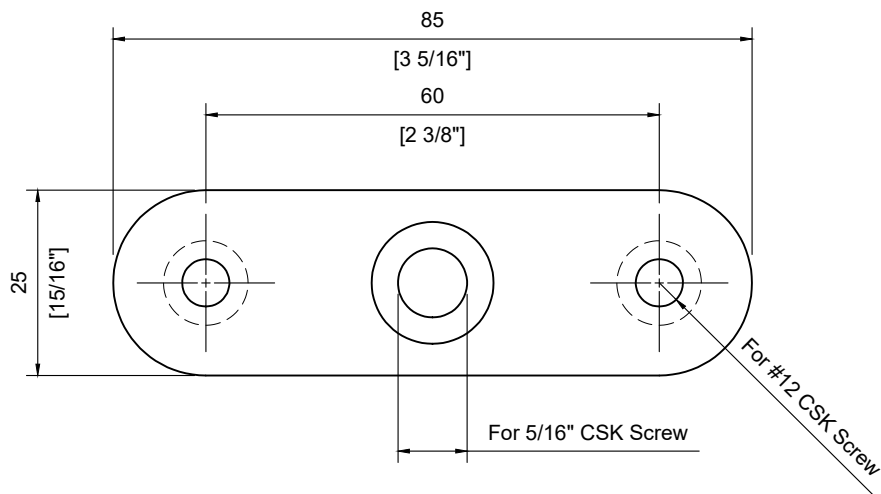

# TECHNICAL SPECIFICATION:

Product Code: #SSHPZAC06  
Description: Flat 90° Handrail Attachment Plate  
Length: 55mm [2-1/8"]  
Width: 25mm [1"]  
Thickness: 5mm [3/16"]  
Material: Stainless Steel 316  
Finish: Satin

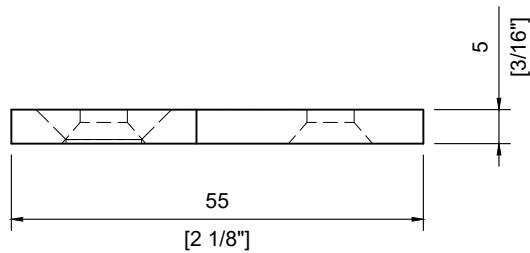
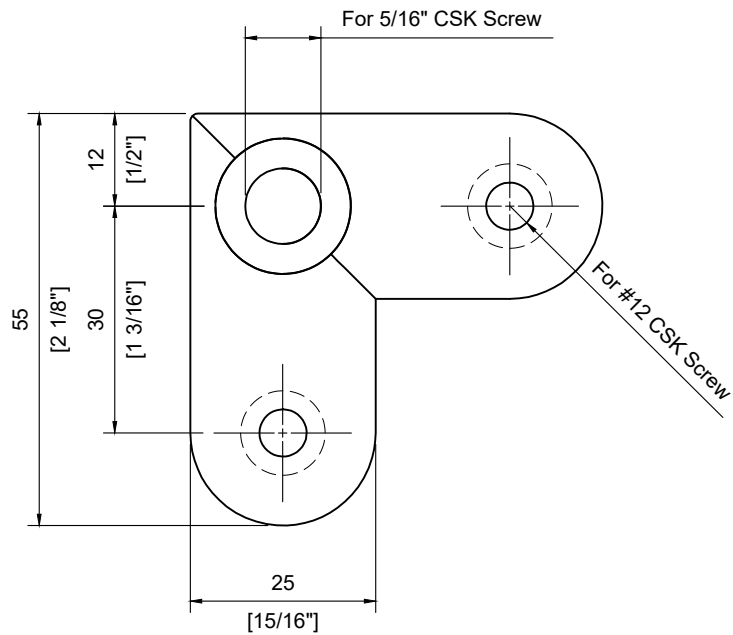

# TECHNICAL SPECIFICATION:

Product Code: **#SSHPZAC07**  
Description: Straight Post Single Arm Spider  
Length: 95mm [3-3/4"]  
Height: 40mm [1-9/16"]  
Hole Distance: 60mm [Ø2-3/8"]  
Material: Stainless Steel 316  
Finish: Satin

## INCLUDED:

Stainless Steel Screw 3/8"-16 x 32mm [1 1/4"] Flat Head Screw

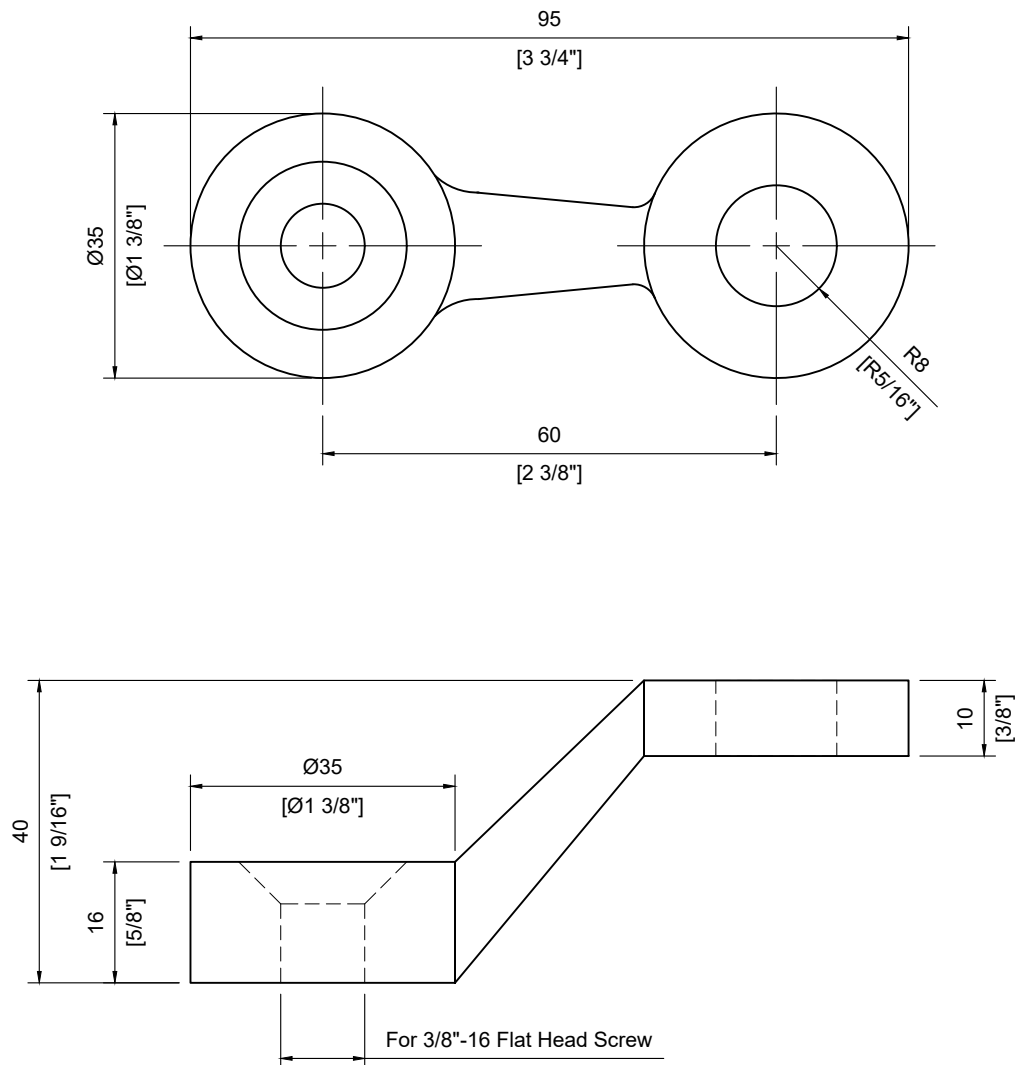

# TECHNICAL SPECIFICATION:

Product Code: **#SSHYZAC08**  
Description: Straight Post Double Arm Spider  
Length: 155mm [6-1/8"]  
Height: 40mm [1-9/16"]  
Hole Distance: 120mm [Ø4-3/4"]  
Material: Stainless Steel 316  
Finish: Satin

## INCLUDED:

Stainless Steel Screw 3/8"-16 x 32mm [1 1/4"] Flat Head Screw

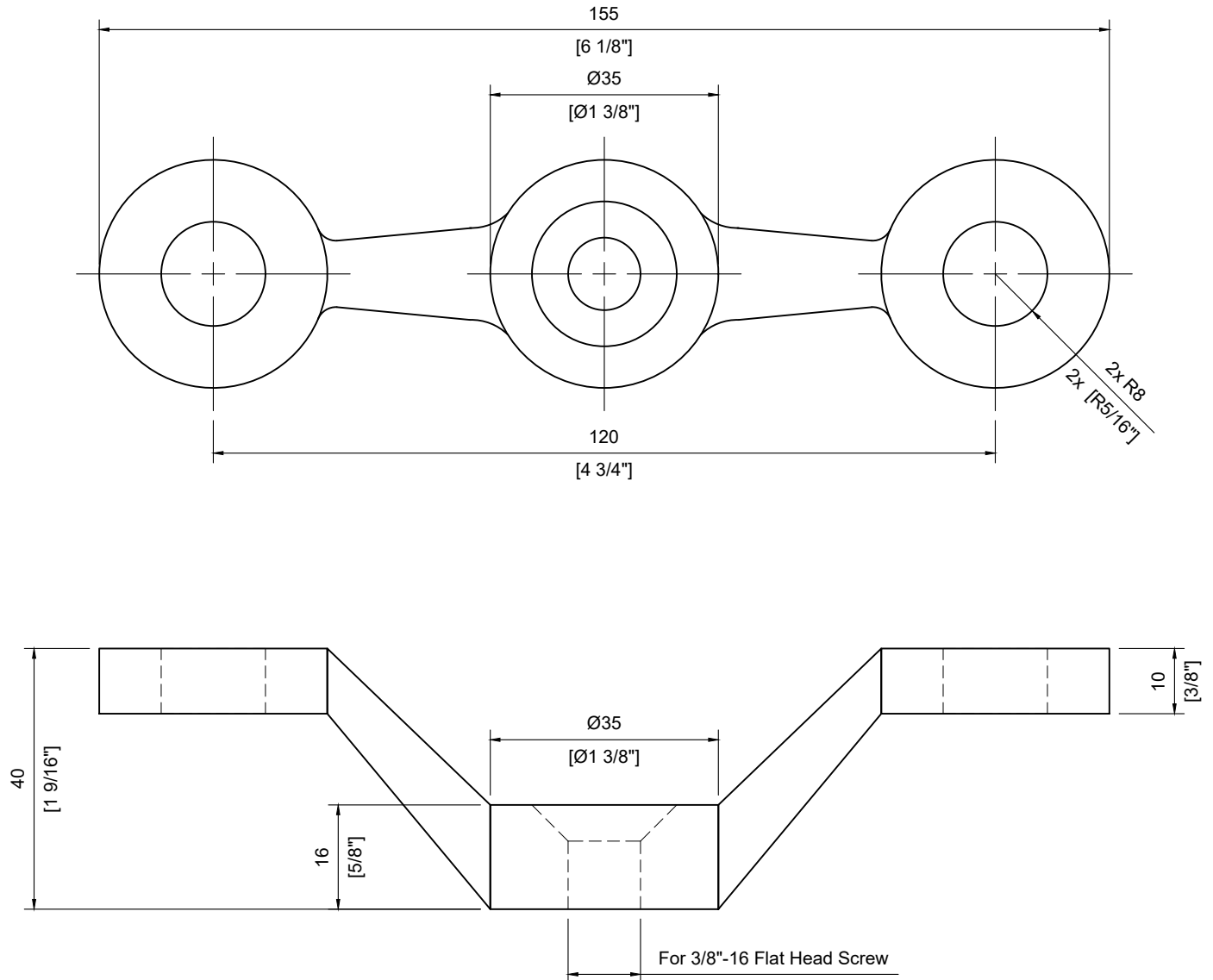

TECHNICAL SPECIFICATION:

Product Code: #SSHPZAC09  
Description: Glass Connector Adapter for Round Post  
Size: Ø35mm [1-3/8"]  
Thickness: 5mm [3/16"]  
Material: Stainless Steel 316  
Finish: Satin

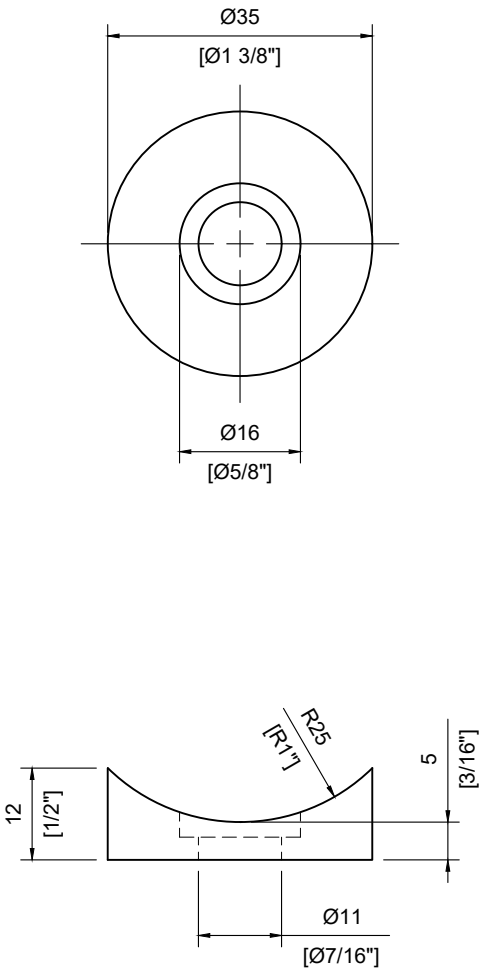

# TECHNICAL SPECIFICATION:

Product Code: **#SSHPZAC10**  
Description: Fixed Glass Spider Connector  
Glass Thickness: 12mm [1/2"] to 19mm [3/4"]  
Hole on Glass: 19mm [3/4"]  
Material: Stainless Steel 316  
Finish: Satin

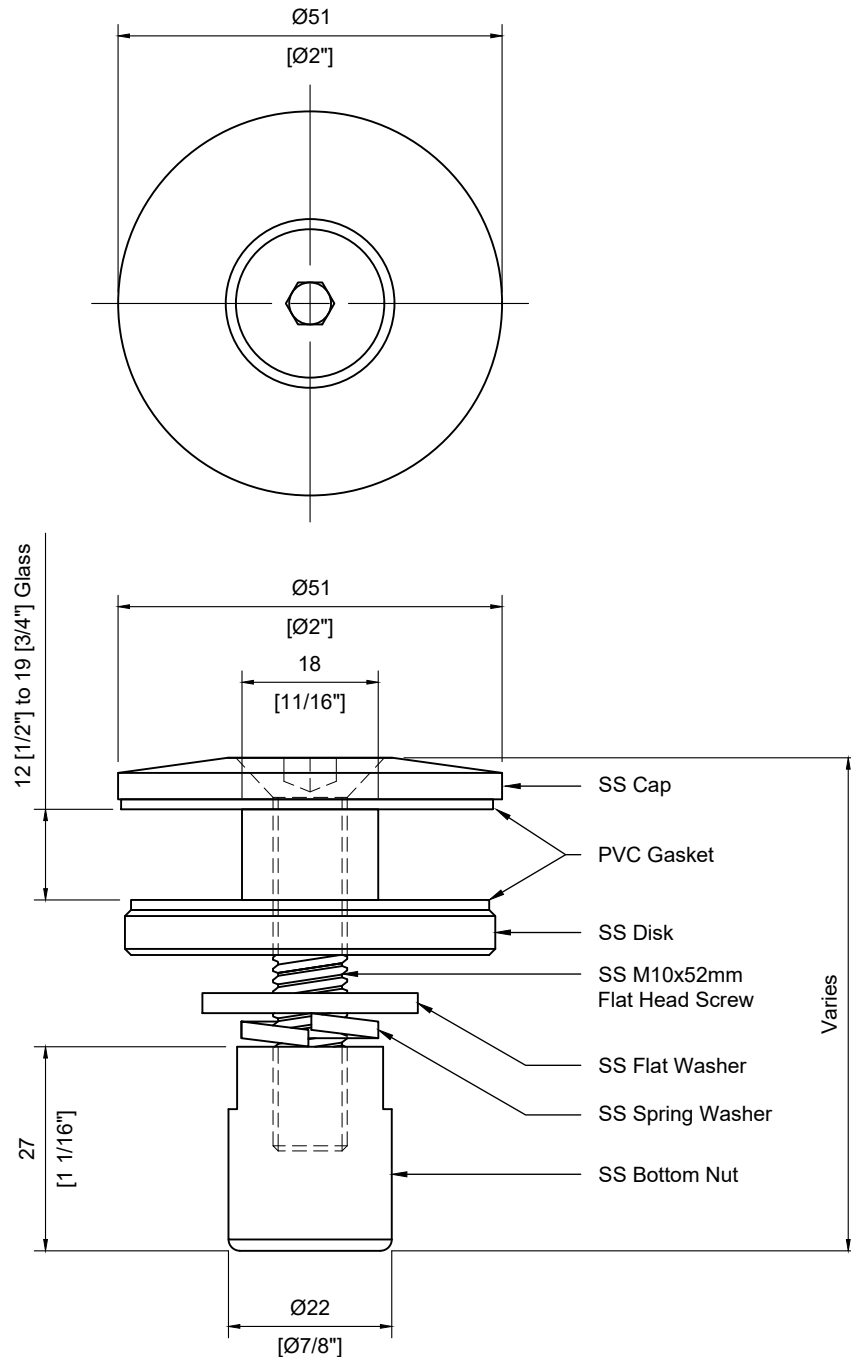

# TECHNICAL SPECIFICATION:

Product Code: **#SSHPZAC11**  
Description: Swivel Glass Spider Connector  
Angle Range: 8°  
Glass Thickness: 12mm [1/2"] to 19mm [3/4"]  
Hole on Glass: 28mm [1 1/8"]  
Material: Stainless Steel 316  
Finish: Satin

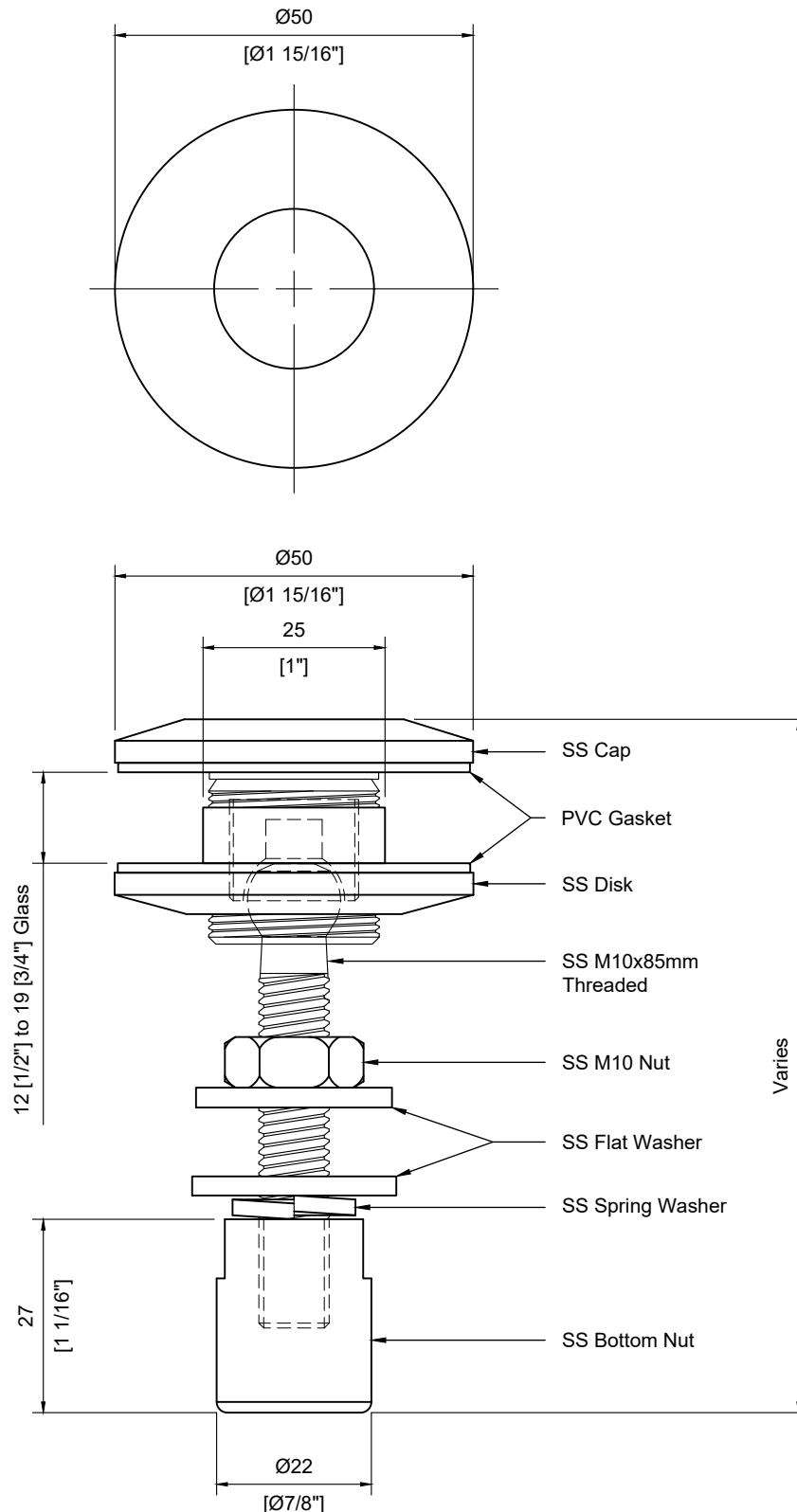

# TECHNICAL SPECIFICATION:

Product Code: **#SSH PZAC12**  
Description: Fixed Double Arm Glass Connector  
Glass Thickness: 10mm [3/8"] to 19mm [3/4"]  
Hole on Glass: 19mm [3/4"]  
Material: Stainless Steel 316  
Finish: Satin

## INCLUDED:

Stainless Steel Screw 3/8"-16 x 32mm[1 1/4"] Threaded Rod

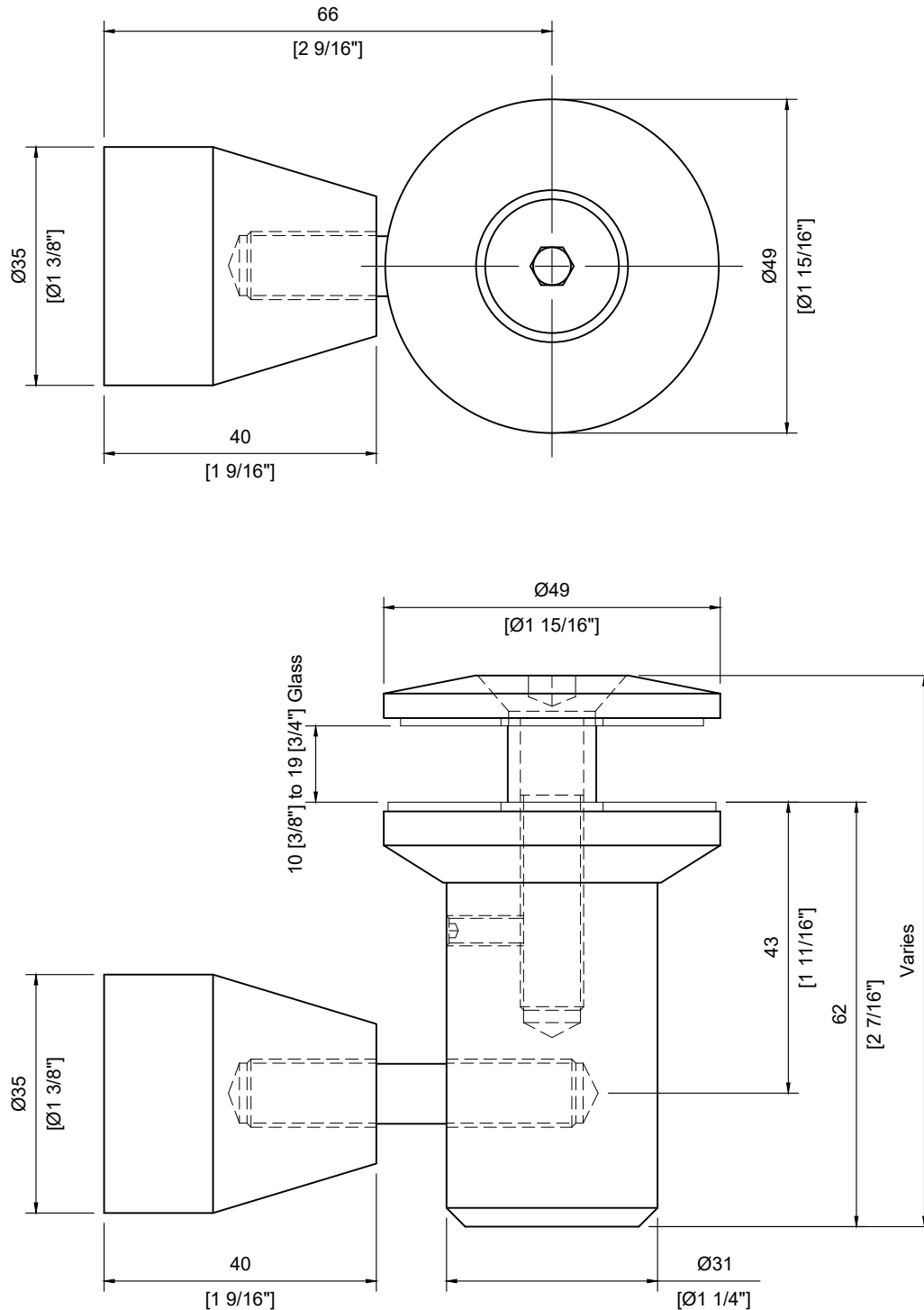

# TECHNICAL SPECIFICATION:

Product Code: **#SSH PZAC13**  
Description: Swivel Double Arm Glass Connector  
Angle Range: 8°  
Glass Thickness: 10mm [3/8"] to 19mm [3/4"]  
Hole on Glass: 19mm [3/4"]  
Material: Stainless Steel 316  
Finish: Satin

## INCLUDED:

Stainless Steel Screw 3/8"-16 x 32mm[1 1/4"] Threaded Rod

