

# LED Lighting Kit Installation Method

## LED Lighting Kit Components and Installation Method

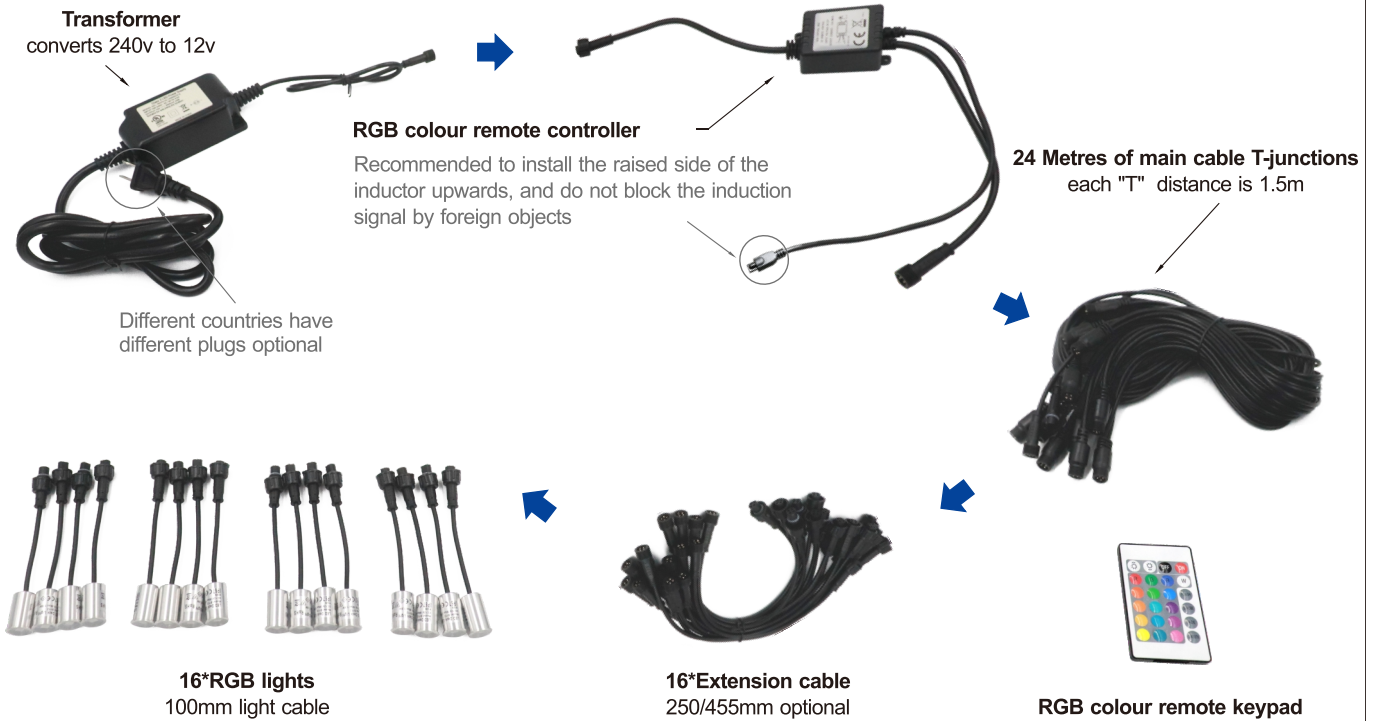

## COMPONENTS

- Transformer, converts 240v to 12v  
(Different countries have different plugs optional)
- RGB colour remote controller  
(Recommended to install the raised side of the inductor upwards, and do not block the induction signal by foreign objects)
- RGB colour remote keypad
- 16\*RGB lights, 100mm light cable
- 16\*Extension cable - 250mm / 455mm
- 24 Metres of main cable T-junctions, each "T" distance is 1.5m

## LED Lighting Kit Features

### FEATURES

- **Designed to fit into LED Pro-fit Spigot S48GPB models**
- 1.5W RGB LED deck light set
- Color: RGB, 16 Light colours to choose from
- 4 mode settings-flash, strobe, fade & smooth
- The speed and brightness adjustment of RGB light available
- Individual color can be set up
- Life: 20,000 hours
- Waterproof Rate: IP67
- Light Size: 16.5\*26mm



**S48GPB**

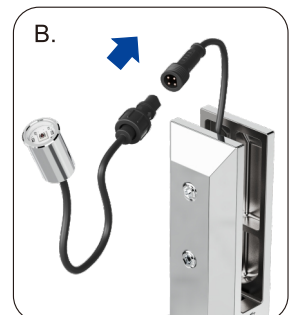
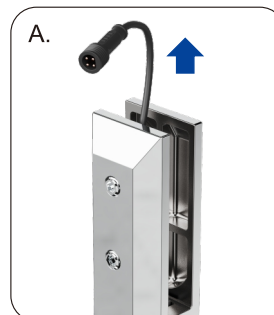

# WiFi LED Controller Instructions



## Technical Parameters:

- Working temperature: -20-60°C
- Input voltage: DC5-24V
- Output power: 100W

## Function mode list:

Symbol	Key note	Symbol	Key note	Symbol	Key note	Symbol	Key note
	Brightness +		Brightness-		OFF		ON
	Static red		Static green		Static blue		Static white
	Static orange		Static pea green		Static dark blue		3 color jump
	Static dark yellow		Static cyan		Static brown		3 color fade
	Static straw yellow		Static light blue		Static pink		7 color fade
	Static yellow		Static sky blue		Static purple		7 color jump

## Instructions:

1. Scan the QR code to download the APP and register the account (**Figure 1**)
2. Connect the controller and led light bar, and turn on the power, open the smart life APP on your mobile phone and click "add device" (as shown in **Figure 2**).
3. (After resetting the device, please complete the network distribution operation within three minutes.) Select lighting (**Figure 3**) → light strip → confirm indicator light in flash (**Figure 4**) Switch power supply 3 times, enter the network configuration in the quick flash, switch power supply 5 times in the flash state, enter the network configuration in the slow flash.) → enter WIFI password (**Figure 5**) → confirm → connect and add successfully → click finish to complete the product matching. (**Figure 6**)



Figure1

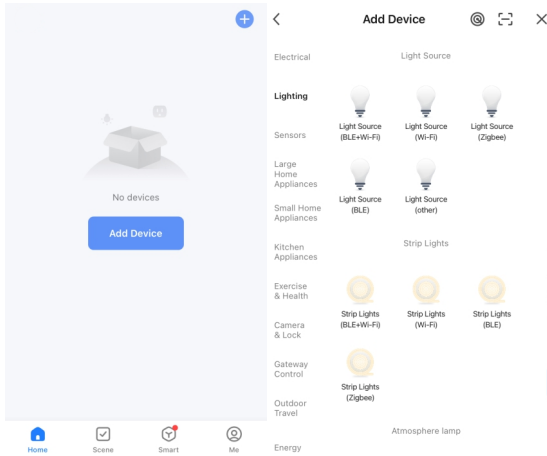

Figure2

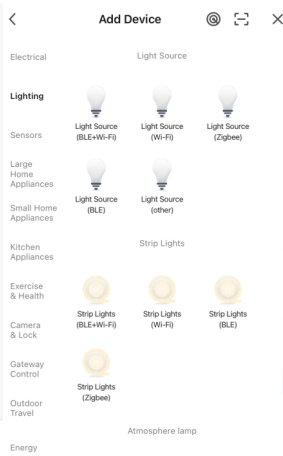

Figure3

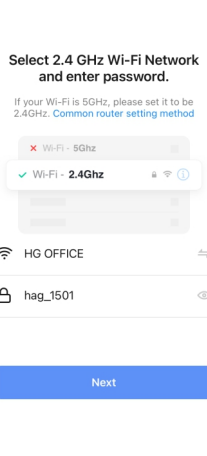

Figure4

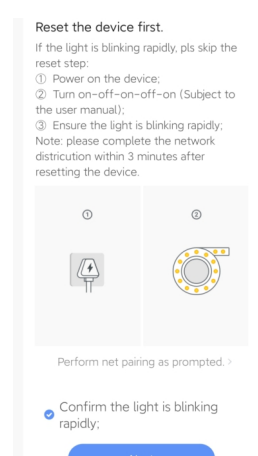

Figure5

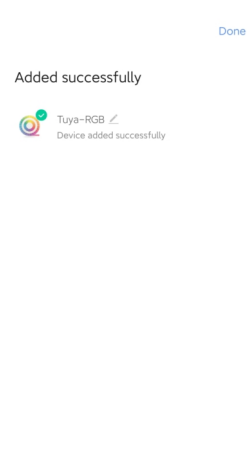

Figure6

4. Enter the main interface of the APP (color light, scene, music, timing)

① Enter the color light interface (**Figure 7**) and click the color ring to set any color (16 million colors) with adjustable brightness.

② When entering the scene interface, you can choose different scenes freely, and the scene can be edited and set. For example, the light mode can be set to be static, and the color such as jumping and breathing and the color conversion speed can be adjusted. The scene can be named freely. (**Figure 8**)

③ When entering the music mode, the light can change with the change of the syllables of the music (**Figure 9**)

④ Enter the timing interface to set the timing. (**Figure 10**)

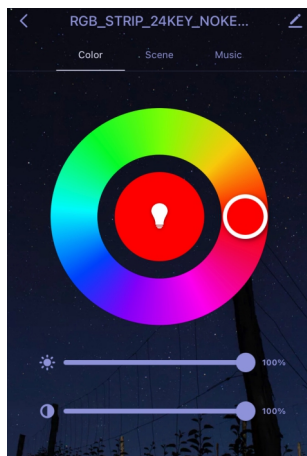

Figure7

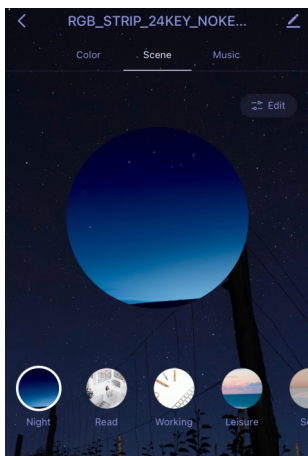

Figure8

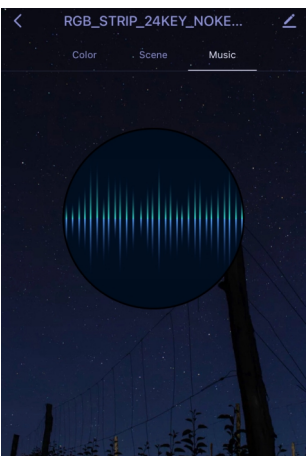

Figure9

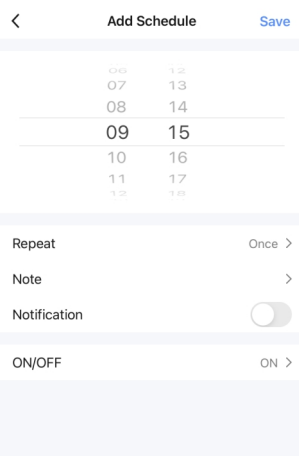

Figure10