

## INSTALLATION INSTRUCTIONS

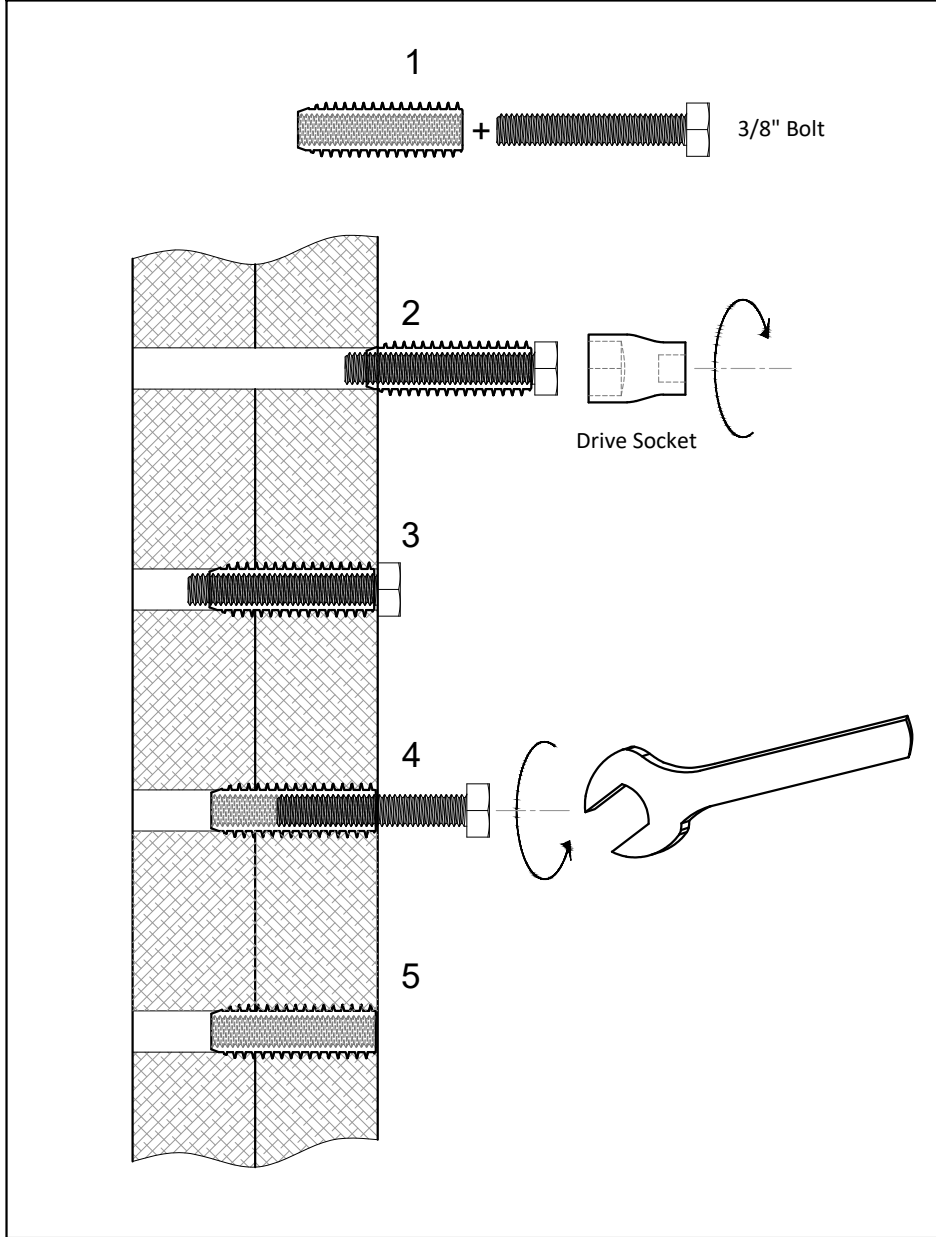

## APPLICATIONS

Wood inserts are installed on wood where there is no access from behind and when internal threads are needed to secure 3/8" bolts, screws and threaded rods.

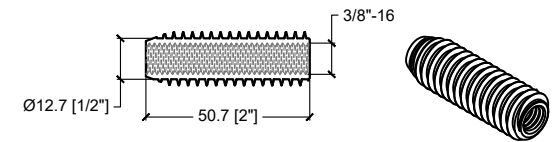
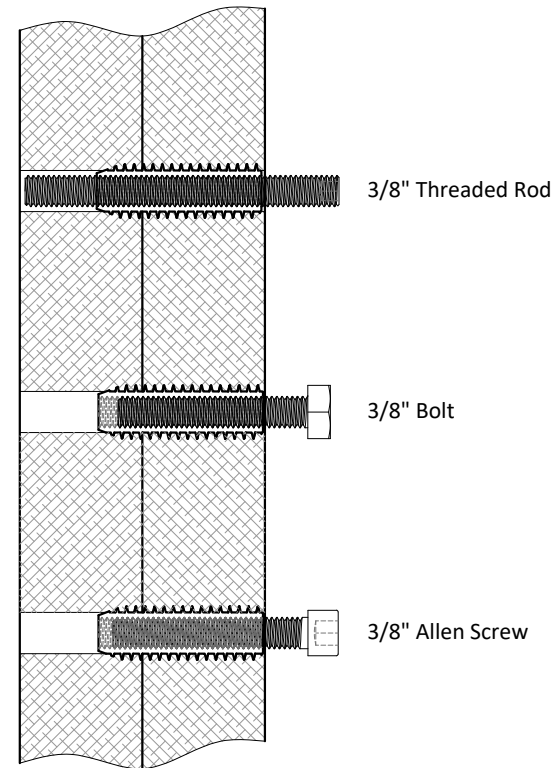

Recommended pilot hole 1/2".

This drawing is the property of Euro Ornamental Forgings Inc. and may not be copied or reproduced in any way whatsoever without express written permission of said company.



127A Aviva Park Dr.,  
Woodbridge, ON, CANADA  
www.euroeac.com  
Toll Free: 1-800-465-7143

REV.: 01  
SHEET: 1 of 1

TITLE:

WOOD INSERT 3/8" X 2"  
# SSKFW382

MATERIAL: SS 304  
FINISH: Bare