

For **Lokk•Latch** only installation , follow Step #1 ▼

LOKK•LATCH

STEP #1 — MAIN LATCH BODY

INSTALLATION PROCEDURE

- This latch is designed to be fitted to the "opening" side of the gate. See notes at right re "handing"
- Ensure the gate frame and the latch post are in alignment (no offset). See dotted line.
- Depending on the model you purchased, the package may contain one or two Post Brackets. Both brackets are suitable for metal gates. The bracket with two side legs is ideal for wood & vinyl gates, but can be used on metal gates as well.

Gap between fence post and gate:

Latch Only:

Post Bracket (No side fixing legs): $\frac{3}{8}$ " - $1\frac{3}{8}$ " (9.5-35mm)

Post Bracket (With side fixing legs): $\frac{3}{8}$ " - $1\frac{1}{8}$ " (9.5-29mm)

Post sizes: 1"-6" (25-150mm)

Tools: Electric or cordless drill, $\frac{5}{32}$ " [4mm] drillbit for pre-drilling metal, $\frac{3}{16}$ " Phillips #2 driver shaft for screws.

1. Determine the approximate height/location of the Latch Body on the fence post. Mark the four fixing holes. (Always predrill metal using the $\frac{5}{32}$ " [4mm] drillbit.)
2. Secure the Latch Body using four wafer-head, self-drilling screws.
3. Locate the Striker Body on the gate frame. Close the gate. Align the Striker Bolt in the centre of the latch tongue (i.e. align the Bolt with the center of rivet). Hold the Striker Body in place and mark the four fixing holes in the center of the fixing slots.
4. Secure the Striker Body to the gate by fixing the remaining self-drilling screws in the center of all four slots. (The Striker is adjustable vertically at any time as required.)
5. Check latching operation to ensure smooth, reliable closure. Your LOKK•LATCH is now ready for use.

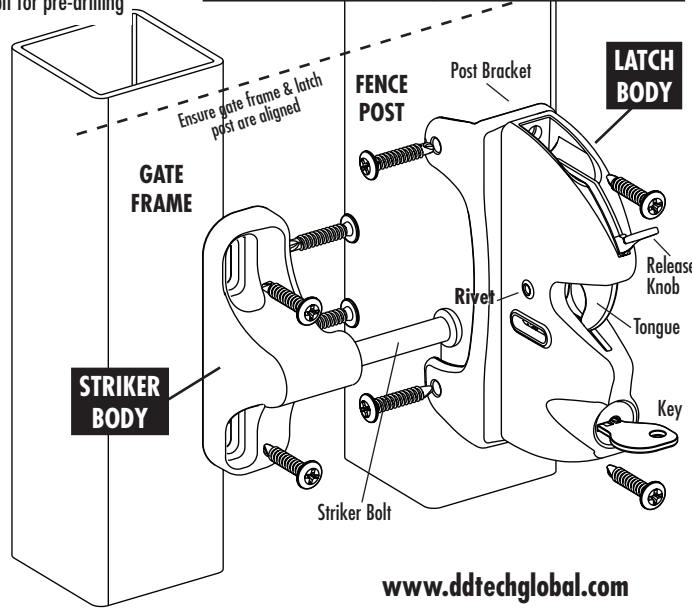
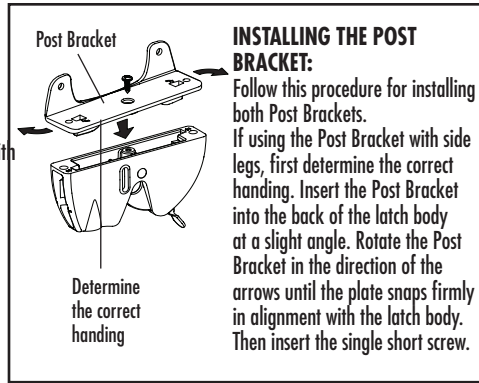

www.ddtechglobal.com

MAINTENANCE: REMOVE KEY/S FROM LOCK/S AFTER USE. Do not lubricate the latch with petroleum-based lubricants at any time - use only powdered graphite. Ensure all screws are tightened firmly and that the Latch Body and/or Access Kit is kept free of dirt, sand and other debris which could impair reliable performance.

WARRANTY & LIMITATION OF LIABILITY: D&D Technologies' ("D&D") products are warranted to be free of defects in materials and workmanship to the original purchaser for as long as he/she owns the product. This product will operate properly, and warranty is valid, only if installed in accordance with the instructions and specifications shown. If a structural defect appears, the original purchaser may return the item, freight prepaid, together with proof of purchase to D&D or its approved international agents. D&D or its agent will, at their discretion, repair or replace the defective item or part without charge to the purchaser. THIS WARRANTY SHALL NOT APPLY WHEN the product has been tampered with, when repairs or attempted repairs have been made by unauthorized persons, where the item has been subjected to misuse, abuse, accident or damage in transit, or where the installer has not followed the instructions set out during installation, operations, or Maintenance requirements. IN NO EVENT SHALL THE COMPANY BE LIABLE FOR ANY INCIDENTAL OR CONSEQUENTIAL DAMAGES. No warranty is given other than that set out above. No other express or implied warranties (including statutory warranties) apply, other than warranties which may not be legally excluded.



D&D Technologies

AUSTRALIA: Unit 6, 4-6 Aquatic Dr, Frenchs Forest NSW 2086
USA: 7731 Woodwind Drive, Huntington Beach, CA 92647

For latch with External Access Kit , follow Step #1, then Step #2 ▼

STEP #2 — EXTERNAL ACCESS KIT

LOKK•LATCH

The External Access Kit (EAK) allows a gate to be opened and locked from the opposite side to the latch. When installed, it is connected to the Latch Body by an Adjustor Rod.

Gap between fence post and gate frame:

Latch + EAK:

Post Bracket (No side fixing legs): $\frac{9}{16}$ " - $1\frac{3}{8}$ " (14.3 - 35mm)

Post Bracket (With side fixing legs): $\frac{9}{16}$ " - $1\frac{1}{8}$ " (14.3 - 29mm)

INSTALLATION PROCEDURE

1. Measure the post depth and add $1\frac{5}{16}$ " (33mm) to that measurement. Wind the Adjustor Lever along the Adjustor Rod so that the Bent End of the Adjustor Rod is this distance away from the Adjustor Lever (see diagram 1).

2. With the latch in the unlocked position, prop the gate open. Slide the Release Knob to the up position at the rear of the Latch Body. Take the adjustable Rod and, holding it vertically, slide the Adjustor Lever through the slot in the side of the Latch Body as shown in diagram 1. Be sure the bent end of the Adjustor Lever protrudes completely through to the other side of the Latch Body.

3. Lower the Release Knob to the down position so that it encloses the Adjustor Lever. Turn the key to lock the Release Knob in place. Rotate the Adjustor Rod to the horizontal position as shown in diagram 2.

4. To aid with installation, the Push Button is locked. Place the Push Button Assembly against the opposite side of the Fence Post from the Latch Body and center it to the Latch Body (see diagram 3). Place the bent return of the Adjustor Rod into the hole on the side of the Push Button as shown in diagram 3 & 4. This will leave the Adjustor Rod at a slight angle, which is normal. Ensure the Adjustor Rod is at the correct length. Rotate the Adjustor Rod, if required, for fine adjustments. The Adjustor Lever within the Latch Body must be at the end of the slot closest to the Fence Post. Mark the angle and position of the Adjustor Rod using a pencil (see diagram 3).

5. With the bent end of the rod firmly inside the hole on the Push Button, slide the Fixing Shroud over the Push Button until the Fixing Shroud is firmly against the Fence Post (see diagram 5). If the Push Button has gone out of position, realign the Adjustor Rod to the mark you earlier made with the pencil.

6. Secure the Fixing Shroud to the Fence Post by using the four self-drilling screws included (Always predrill metal by using the $\frac{5}{32}$ " [4mm] drill bit.) Unlock the Push Button and check for smooth operation. Cut off any excess Adjustor Rod to approximately $\frac{1}{4}$ " (6mm) from the Adjustor Lever. File off any sharp edges to make smooth.

The External Access Kit is ready for use.

(Note: Locking the External Access Kit only locks the Push Button. It does not lock the Latch Body, which is lockable separately).

