

GLASS CLIPS REFERENCE CHART

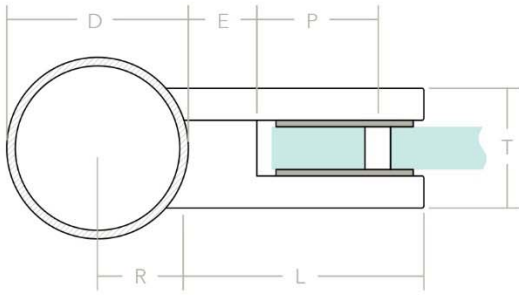

ROUND GLASS CLIPS

PART#	D mm inches	L mm inches	R mm inches	P mm inches	E mm inches	T mm inches
SSGC101XX16S	Flat	50	-	21.5	16	27
	See Note	1.97	-	0.85	0.63	1.06
SSGC106XX16S	38.1	50	19.05	21.5	16	27
	1.50	1.97	0.75	0.85	0.63	1.06
SSGC103XX16S	42.4	50	21.2	21.5	16	27
	1.67	1.97	0.83	0.85	0.63	1.06
SSGC201XX16S SSGC201XXZMS	Flat	63	-	30.5	17.5	30
	See Note	2.48	-	1.20	0.69	1.18
SSGC206XX16S SSGC206XXZMS	38.1	63	19.05	30.5	17.5	30
	1.50	2.48	0.75	1.20	0.69	1.18
SSGC203XX16S SSGC203XXZMS	42.4	63	21.2	30.5	17.5	30
	1.67	2.48	0.83	1.20	0.69	1.18
SSGC207XX16S SSGC207XXZMS	50.8	63	25.4	30.5	17.5	30
	2.00	2.48	1.00	1.20	0.69	1.18

LEGEND

- D:** Tube size
- L:** Length of glass clip
- R:** Back of clip to the center of post
- P:** Center of pin to internal edge of glass clip

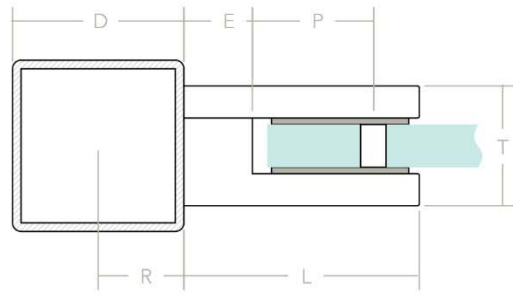

SQUARE GLASS CLIPS

PART#	D mm inches	L mm inches	R mm inches	P mm inches	E mm inches	T mm inches
SSGC301XX16S SSGC301XXZMB	Flat	45	-	17	18	26
	See Note	1.77	-	0.67	0.71	1.02
SSGC306XX16S	38.1	45	19.05	17	18	26
	1.50	1.77	0.75	0.67	0.71	1.02
SSGC303XX16S	42.4	45	21.2	17	18	26
	1.67	1.77	0.83	0.67	0.71	1.02
SSGC431XX16S SSGC431XXZMS SSGC431XXZMB SSGC431XXZMW	Flat	55	-	26.5	18	35
	See Note	2.17	-	1.04	0.71	1.38
SSGC411XX16S SSGC411XXZMS SSGC411XXZMB	42.4	55	21.2	26.5	18	35
	1.67	2.17	0.83	1.04	0.71	1.38
SSGC437XX16S SSGC417XX16S	50.8	55	25.4	26.5	18	35
	2.00	2.17	1.00	1.04	0.71	1.38
SSGC441XX16S	Flat	55	-	26.5	18	40
	See Note	2.17	-	1.04	0.71	1.57
SSGC451XX16S	Flat	55	-	26.5	18	44
	See Note	2.17	-	1.04	0.71	1.73

NOTE: Flat Glass Clips are installed on a wall or different sizes of square tubing (e.g., 40 x 40mm, 2" x 2").
For installation on square tubing, D = Tube Size and R = D/2.

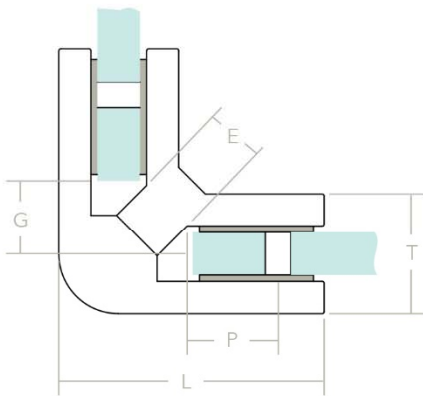

90°

PART#	L mm inches	P mm inches	E mm inches	G mm inches	T mm inches
SSGC014XX16S	82	33	15.5	15	30
	3.23	1.30	0.61	0.59	1.18

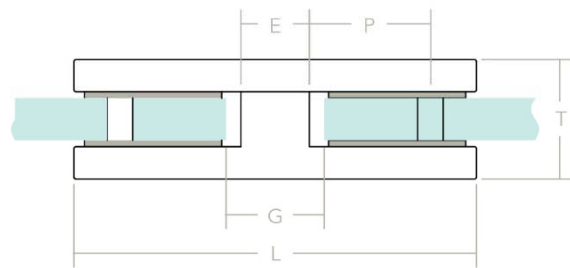

180°

PART#	L mm inches	P mm inches	E mm inches	G mm inches	T mm inches
SSGC015XX16S	106	30	14	19	30
	4.17	1.18	0.55	0.75	1.18

LEGEND

- L:** Length of glass clip
- P:** Center of pin to internal edge of glass clip
- E:** Internal edge to edge distance
- G:** Glass to glass gap