

Hole Detail

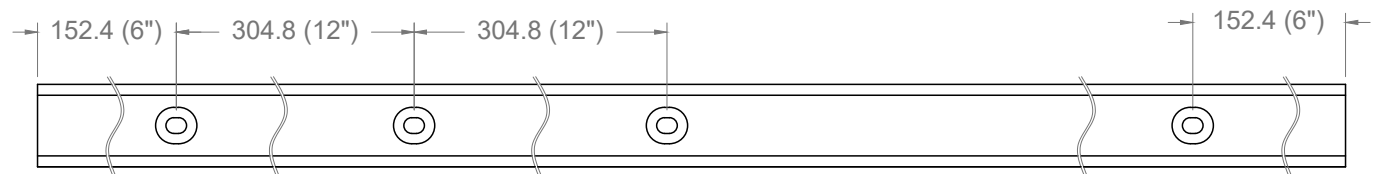

Top View

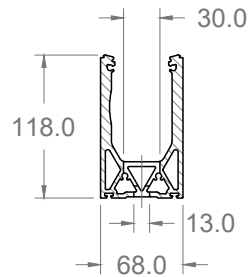

Product Code:
 SSSM3SHOE10A (10 ft.)
 SSSM3SHOE20A (20 ft.)



127A Aviva Park Dr., Woodbridge, ON, CANADA
 www.euroeac.com | Toll Free: 1-800-465-7143

MATERIAL: Al. 6063-T6
 WEIGHT: 20.5 Kg/m
 SCALE: As Noted
 DRAWN: A.R
 DATE: 06/12/2017

TITLE
 Tilt-Lock Shoe - Top Mount
 With Brush Anodized Al. Cladding

DWG NO SSSM3SHOE10/20A

SHEET
 1 of 1
 REV
 01